



Single Family

214 Grand Summit Drive

Anncville, PA 17003

COMMUNITY SALES MANAGER

Nicole Wamsher

Call/Text 717-690-5746



SALE PENDING

Plan: Cooper

2 Bedrooms

2.0 Bathrooms

1,884 Sq. Ft.

SALE PENDING -- Convenient, single story living in the new Winding Creek 55+ community is complete with an inviting front porch and 9' ceilings. A 2-car garage with mudroom entry features a craftsman bench seat and laundry room access. Beautiful luxury vinyl plank flooring in the foyer extends throughout the main living areas. A convenient study, secondary bedroom, and full bathroom are located to the front of the home. The family room is warmed by a gas fireplace with a stone surround and mantel. The open kitchen is well-equipped with attractive cabinetry, upgraded appliances, and quartz countertops with a tile backsplash. Adjacent to the kitchen is the sunny dining area with access to the rear patio. The owner's suite is quietly tucked to the back of the home and includes an expansive closet and a private bathroom with a tile shower and double bowl vanity.



FIRST FLOOR

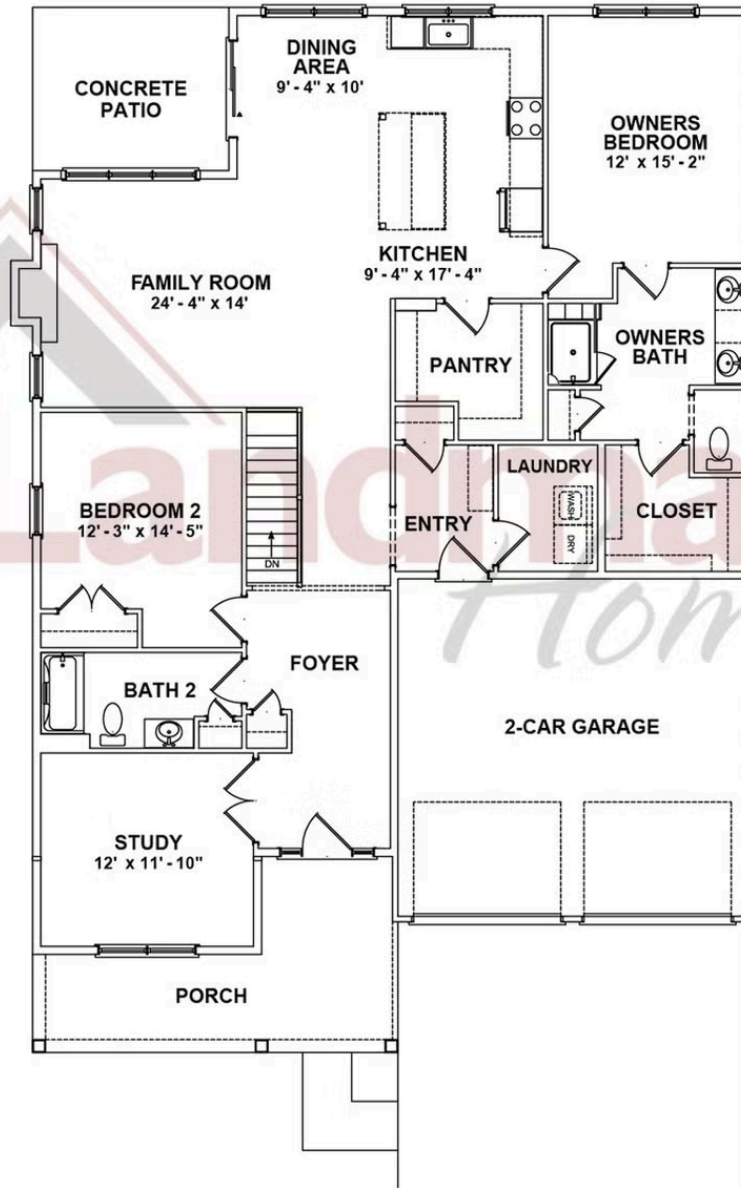

© 2024 Landmark Builders, Inc. We enforce our intellectual property rights to the fullest extent permitted by applicable law. Elevations and landscaping are artists' conceptions only. Floor plans may vary depending on elevation selected. Actual construction documents take precedence over artwork.