



Single Family
124 Morning Drive
Ephrata, PA 17522

COMMUNITY SALES MANAGER

Katie Will

Call/Text 717-824-7942

SALE PENDING



SALE PENDING

Plan: Amberbrook

5 Bedrooms

3.0 Bathrooms

3,335 Sq. Ft.

SALE PENDING -- This thoughtfully designed 2-story home with 5 bedrooms, including one on the first floor, features 9' ceilings on the first floor and luxury vinyl plank flooring throughout the main living areas. The 2-car garage with an extra storage area opens to a mudroom complete with built-in lockers. The kitchen is well-equipped with stainless steel appliances, quartz countertops, a tile backsplash, and a large center island and pantry. The dining area provides access to a screened in, covered patio with plenty of privacy and the family room is warmed by a gas stone fireplace. On the second floor, the owner's suite includes a private bathroom with a tile shower, double bowl vanity and an expansive closet. Adjacent to the suite are 3 additional spacious bedrooms with large closets, a full bathroom, laundry room and loft space.





Single Family
124 Morning Drive
Ephrata, PA 17522

COMMUNITY SALES MANAGER

Katie Will

Call/Text 717-824-7942

FIRST FLOOR

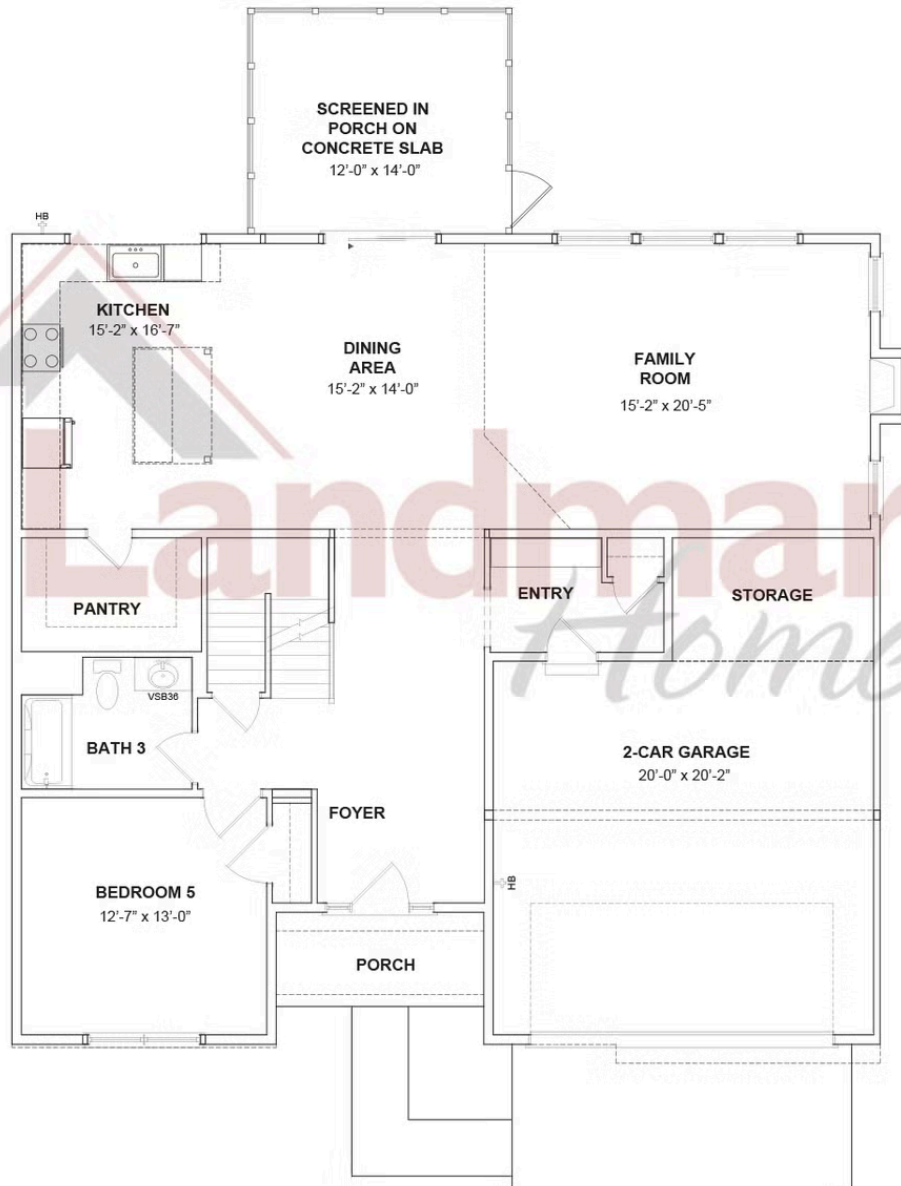

© 2025 Landmark Builders, Inc. We enforce our intellectual property rights to the fullest extent permitted by applicable law. Elevations and landscaping are artists' conceptions only. Floor plans may vary depending on elevation selected. Actual construction documents take precedence over artwork.





Single Family
124 Morning Drive
Ephrata, PA 17522

COMMUNITY SALES MANAGER

Katie Will

Call/Text 717-824-7942

SECOND FLOOR

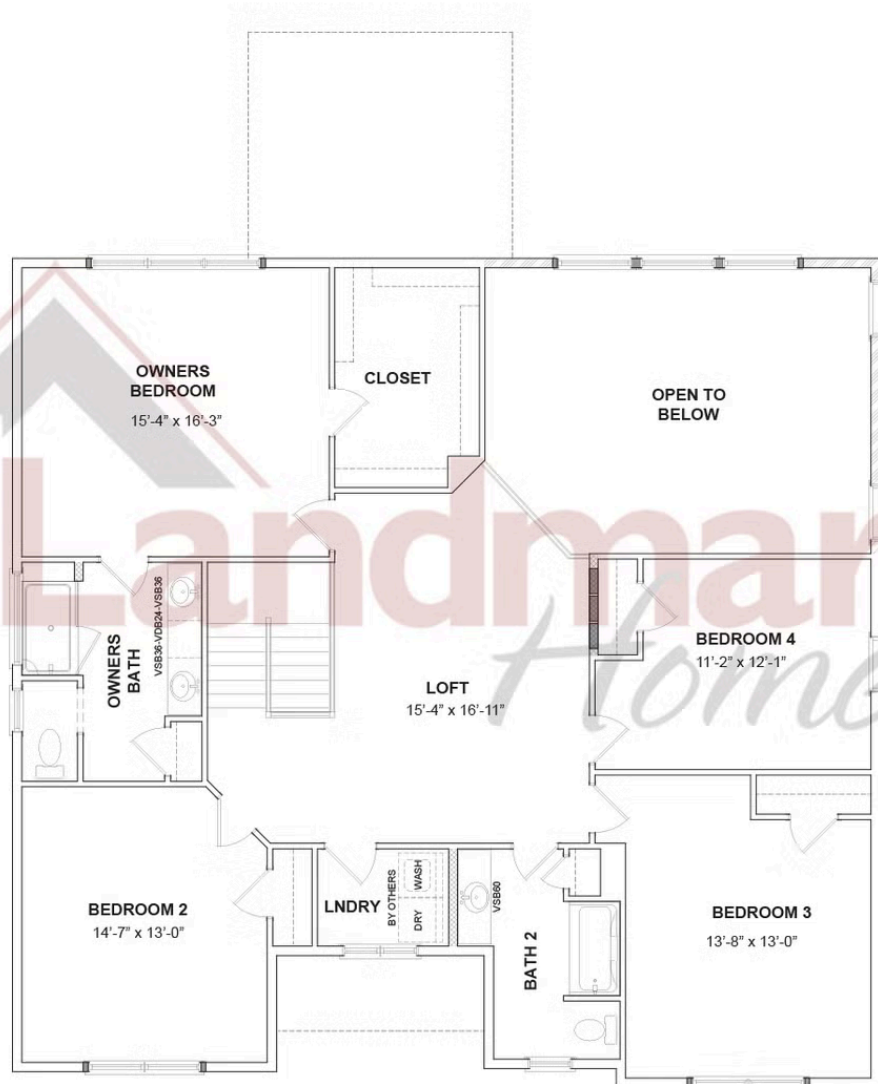

© 2025 Landmark Builders, Inc. We enforce our intellectual property rights to the fullest extent permitted by applicable law. Elevations and landscaping are artists' conceptions only. Floor plans may vary depending on elevation selected. Actual construction documents take precedence over artwork.

Document generated 2/22/26

