



Duplex  
**31 Glenn View**  
Carlisle, PA 17013

**COMMUNITY SALES MANAGER**

Dontell Robinson

Call/Text 717-669-2196

**MOVE-IN READY**



Home Priced at  
**\$352,100**

Plan: Linden

3 Bedrooms

2.5 Bathrooms

2,060 Sq. Ft.

This charming 3-story townhome includes a 2-car garage, finished basement, and a patio for outdoor living. On the main level, the spacious living room flows effortlessly to the kitchen & dining. The kitchen features beautiful cabinetry with quartz countertops and tile backsplash, stainless-steel appliances, and center island. So much natural light shines in with large windows surrounding the sides and rear access to the patio & yard. On the 2nd floor, the owner's suite includes a private bathroom and an expansive closet. Two additional bedrooms, a full bathroom, and a laundry closet further complete the 2nd floor. Just minutes from downtown Carlisle and Mechanicsburg, The Village at North Ridge provides convenience with a tranquil peaceful environment with mountain views.

Document generated 12/25/25



OPTIONAL FIRST FLOOR PLAN  
 W/ FINISHED BASEMENT

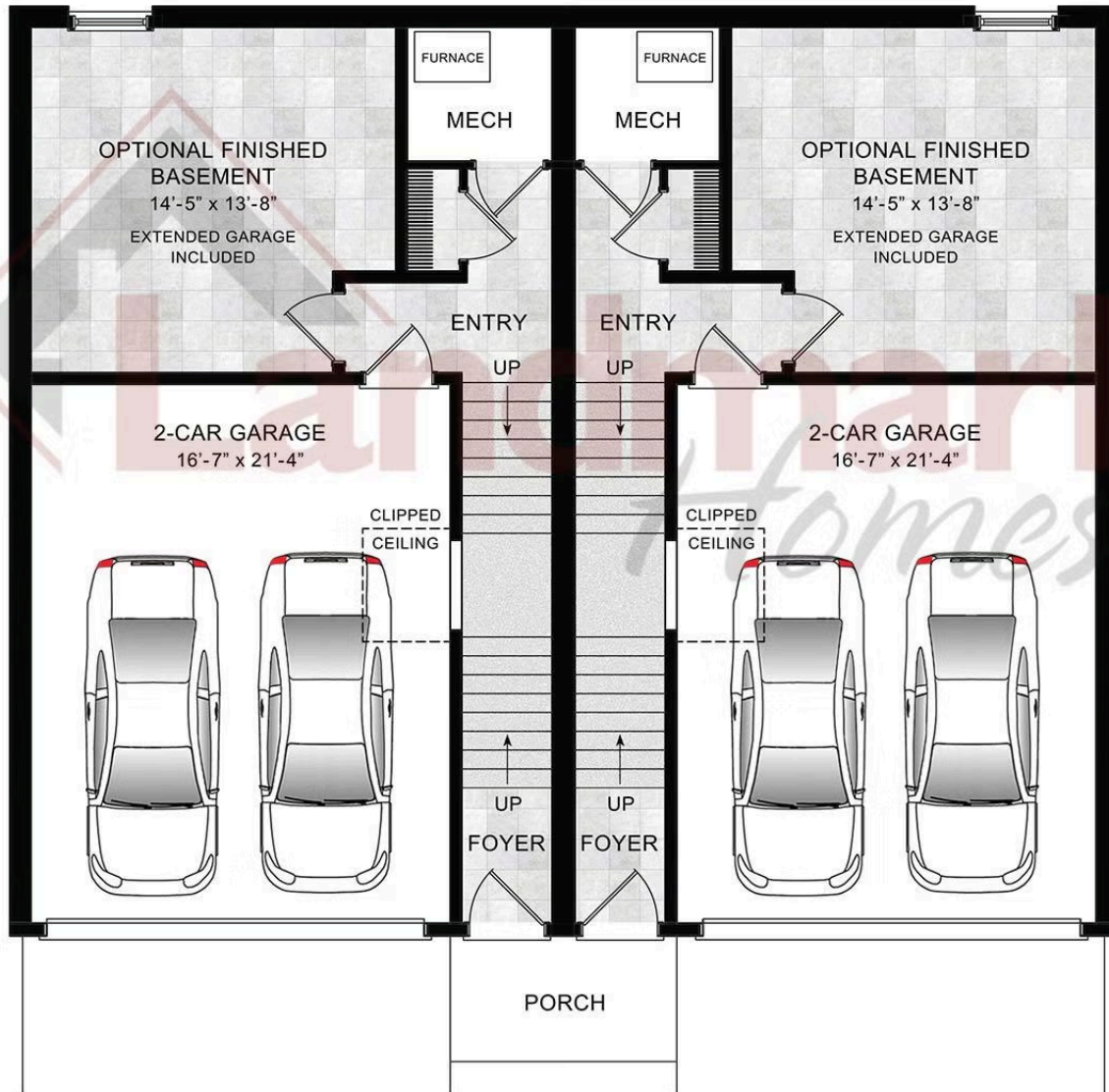

© 2023 Landmark Builders, Inc. We enforce our intellectual property rights to the fullest extent permitted by applicable law. Elevations and landscaping are artists' conceptions only. Floor plans may vary depending on elevation selected. Actual construction documents take precedence over artwork.

Linden

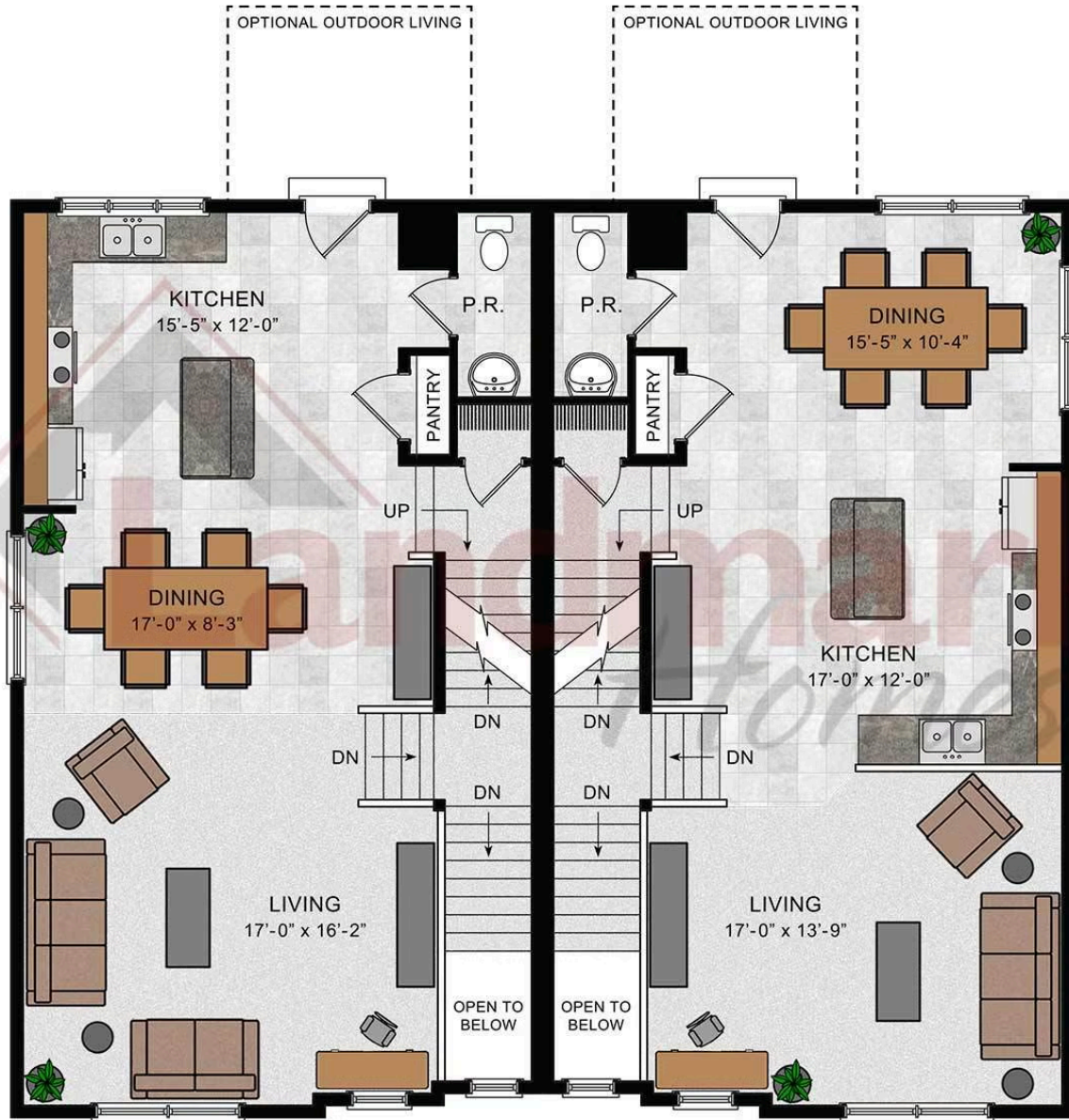

SECOND FLOOR

© 2023 Landmark Builders, Inc. We enforce our intellectual property rights to the fullest extent permitted by applicable law. Elevations and landscaping are artists' conceptions only. Floor plans may vary depending on elevation selected. Actual construction documents take precedence over artwork.

Linden

## THIRD FLOOR

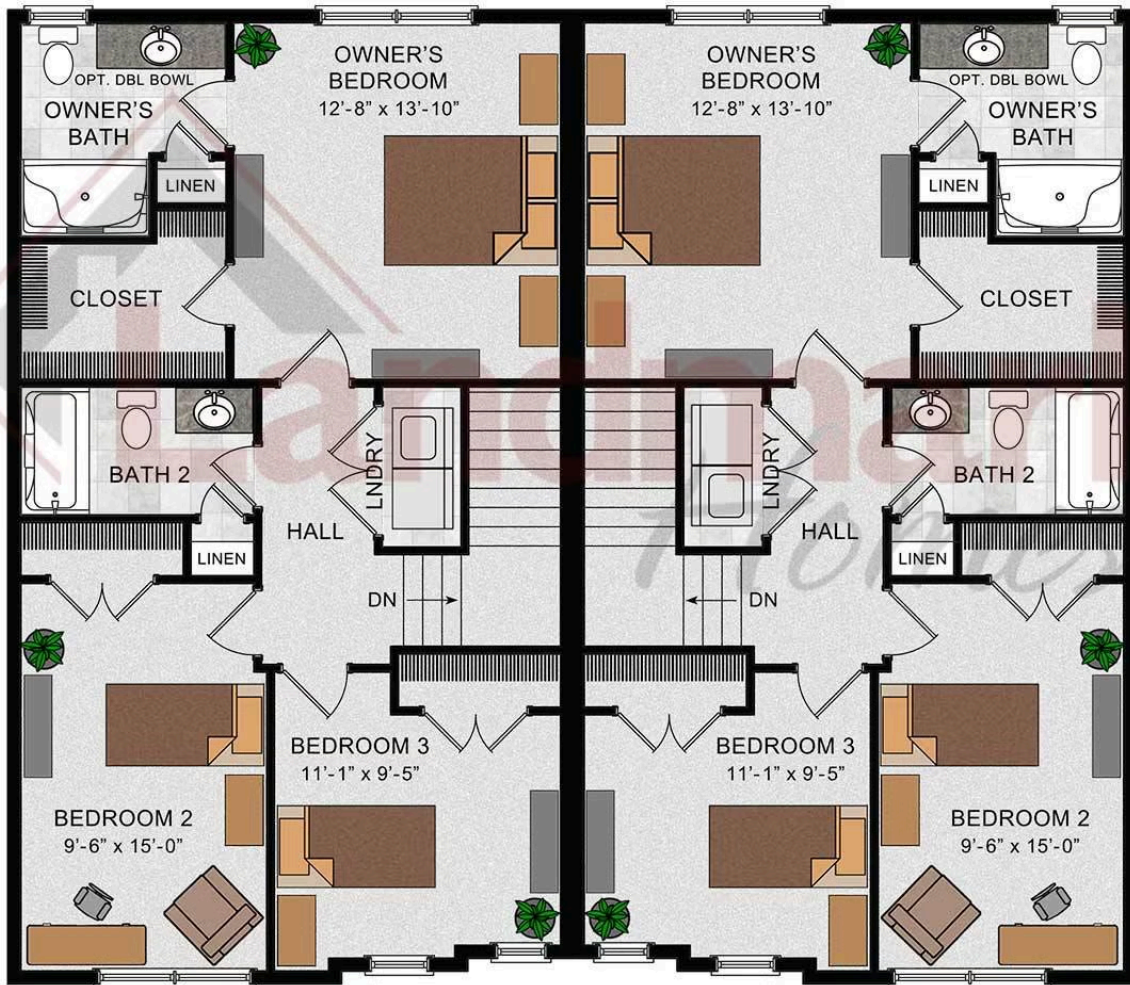

© 2023 Landmark Builders, Inc. We enforce our intellectual property rights to the fullest extent permitted by applicable law. Elevations and landscaping are artists' conceptions only. Floor plans may vary depending on elevation selected. Actual construction documents take precedence over artwork.