



Townhome  
**164 Marissa Court**  
Newmanstown, PA 17073

**COMMUNITY SALES MANAGER**

Kristin Larusso

Call/Text 717-419-1611

**SALE PENDING**



**SALE PENDING**

Plan: Linden

Elevation: Linden Exterior

3 Bedrooms

2.5 Bathrooms

1,992 Sq. Ft.

**\*SALE PENDING\* -- UNDER CONSTRUCTION – AVAILABLE THIS WINTER:** This 3-story, end-of-row townhome includes a 2-car garage, finished bonus room, and a patio for outdoor living. On the main level, the spacious living room opens to the dining area and kitchen. The kitchen features attractive cabinetry, quartz countertops, stainless-steel appliances, and access to the rear patio. On the 2nd floor, the owner's suite includes a private bathroom and an expansive closet. Two additional bedrooms, a full bathroom, and a laundry closet complete the 2nd floor.



OPTIONAL FIRST FLOOR PLAN  
 W/ FINISHED BASEMENT

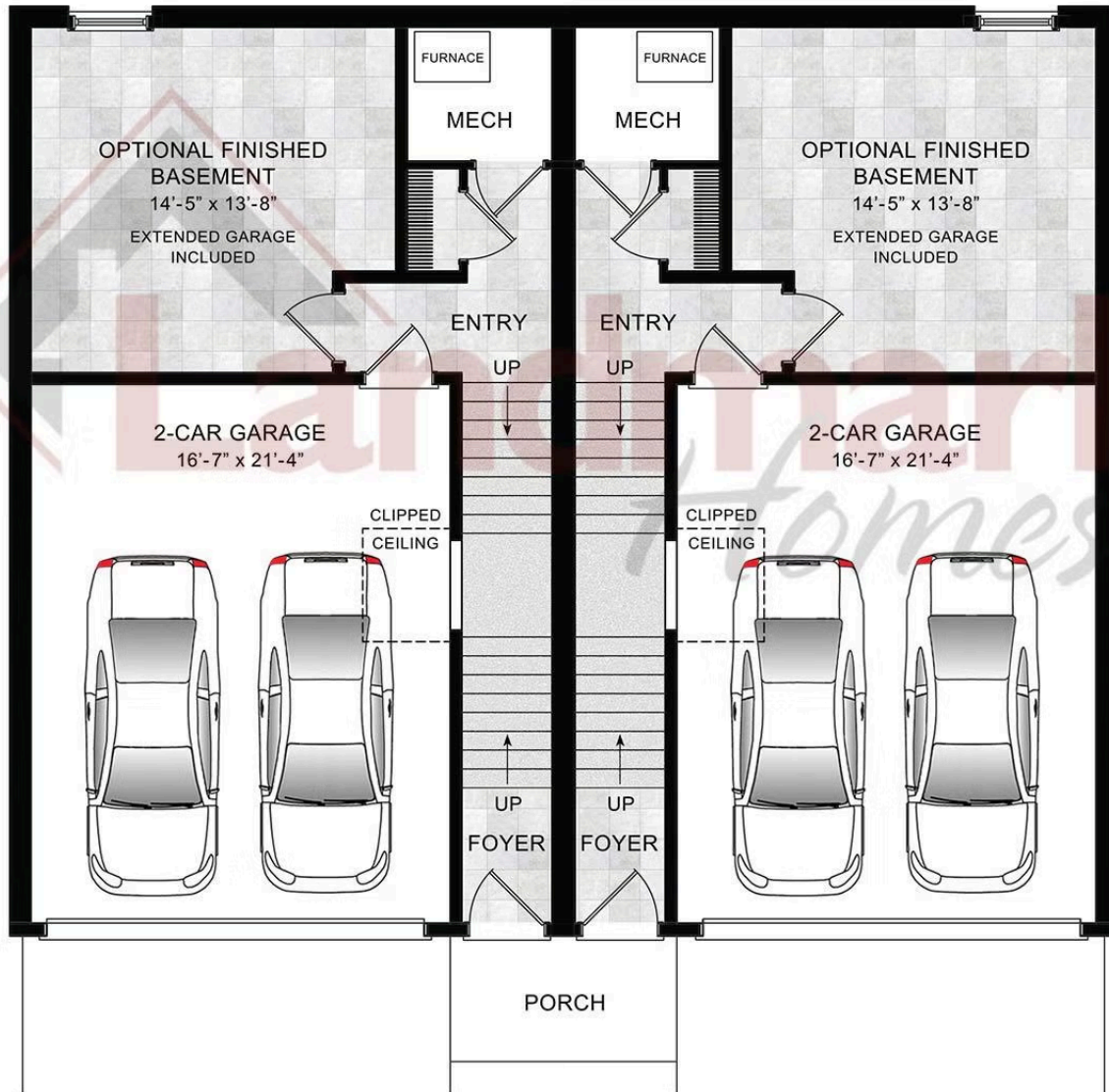

© 2023 Landmark Builders, Inc. We enforce our intellectual property rights to the fullest extent permitted by applicable law. Elevations and landscaping are artists' conceptions only. Floor plans may vary depending on elevation selected. Actual construction documents take precedence over artwork.

Linden

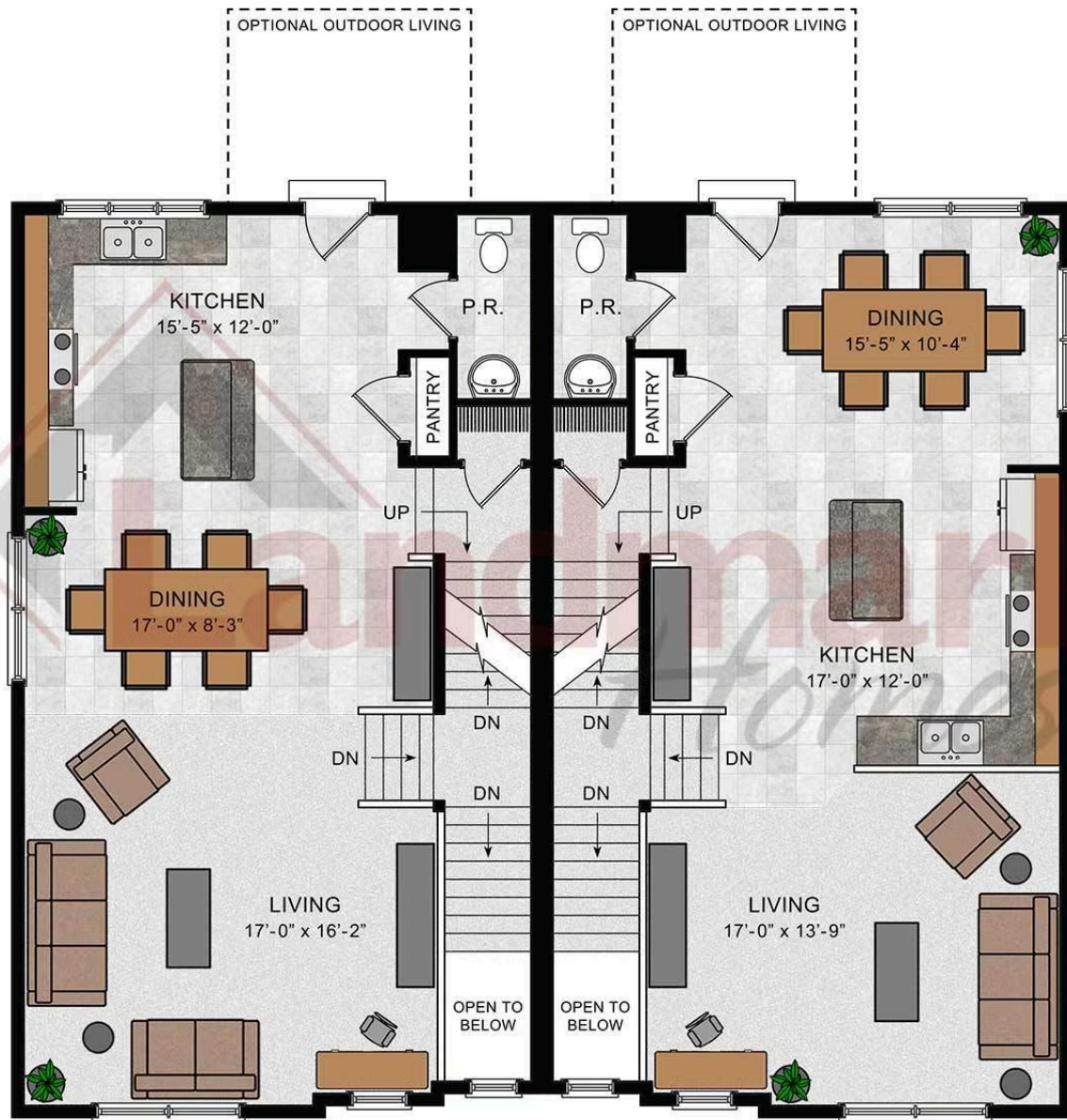

SECOND FLOOR

© 2023 Landmark Builders, Inc. We enforce our intellectual property rights to the fullest extent permitted by applicable law. Elevations and landscaping are artists' conceptions only. Floor plans may vary depending on elevation selected. Actual construction documents take precedence over artwork.



Linden

## THIRD FLOOR

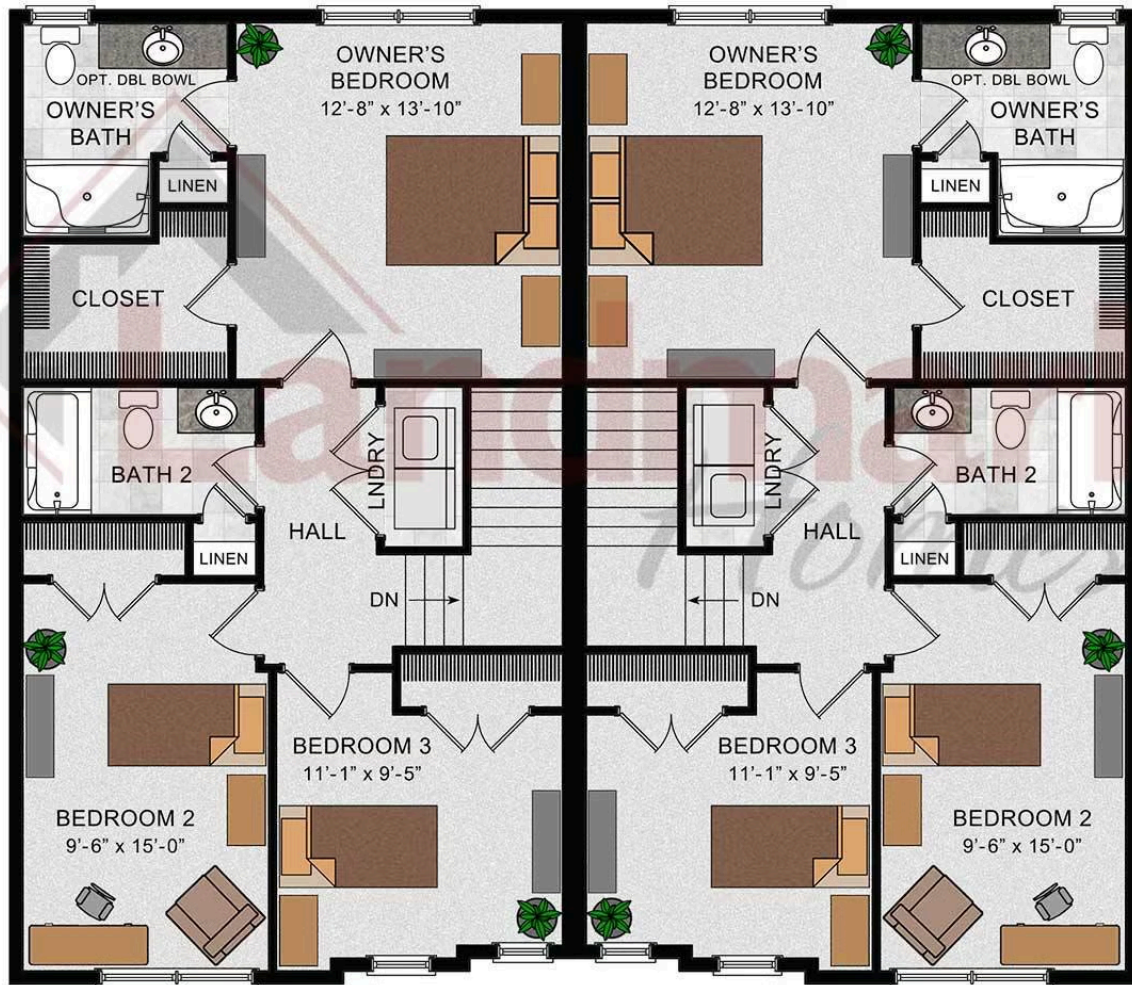

© 2023 Landmark Builders, Inc. We enforce our intellectual property rights to the fullest extent permitted by applicable law. Elevations and landscaping are artists' conceptions only. Floor plans may vary depending on elevation selected. Actual construction documents take precedence over artwork.