



Single Family

217 Copper Ridge Drive

Newmanstown, PA 17073

COMMUNITY SALES MANAGER

Kristin Larusso

Call/Text 717-419-1611

MOVE-IN READY



Home Priced at
\$569,700

Plan: Darien

4 Bedrooms

2.5 Bathrooms

2,696 Sq. Ft.

This beautiful home with a welcoming front porch includes a 2-car garage with a large mudroom entry. The first floor and daylight basement boast 9' ceilings and stylish vinyl plank flooring in the main living areas. To the front of the home is a convenient, carpeted flex room that can be used as a study, living room, or other versatile space. The kitchen is well-appointed with quartz countertops, a tile backsplash, stainless-steel appliances, and a large pantry. The sunny dining area provides access to a rear deck. Open to the kitchen, the comfortable family room is warmed by a gas fireplace with a stone surround and box beam mantel. The 2nd floor owner's suite features an expansive closet and a private bathroom with a 5' shower and double bowl vanity. Adjacent to the suite are 3 additional bedrooms, a full bathroom, a spacious rec room, and a convenient laundry room.

Document generated 2/14/26





Single Family

217 Copper Ridge Drive

Newmanstown, PA 17073

COMMUNITY SALES MANAGER

Kristin Larusso

Call/Text 717-419-1611

FIRST FLOOR

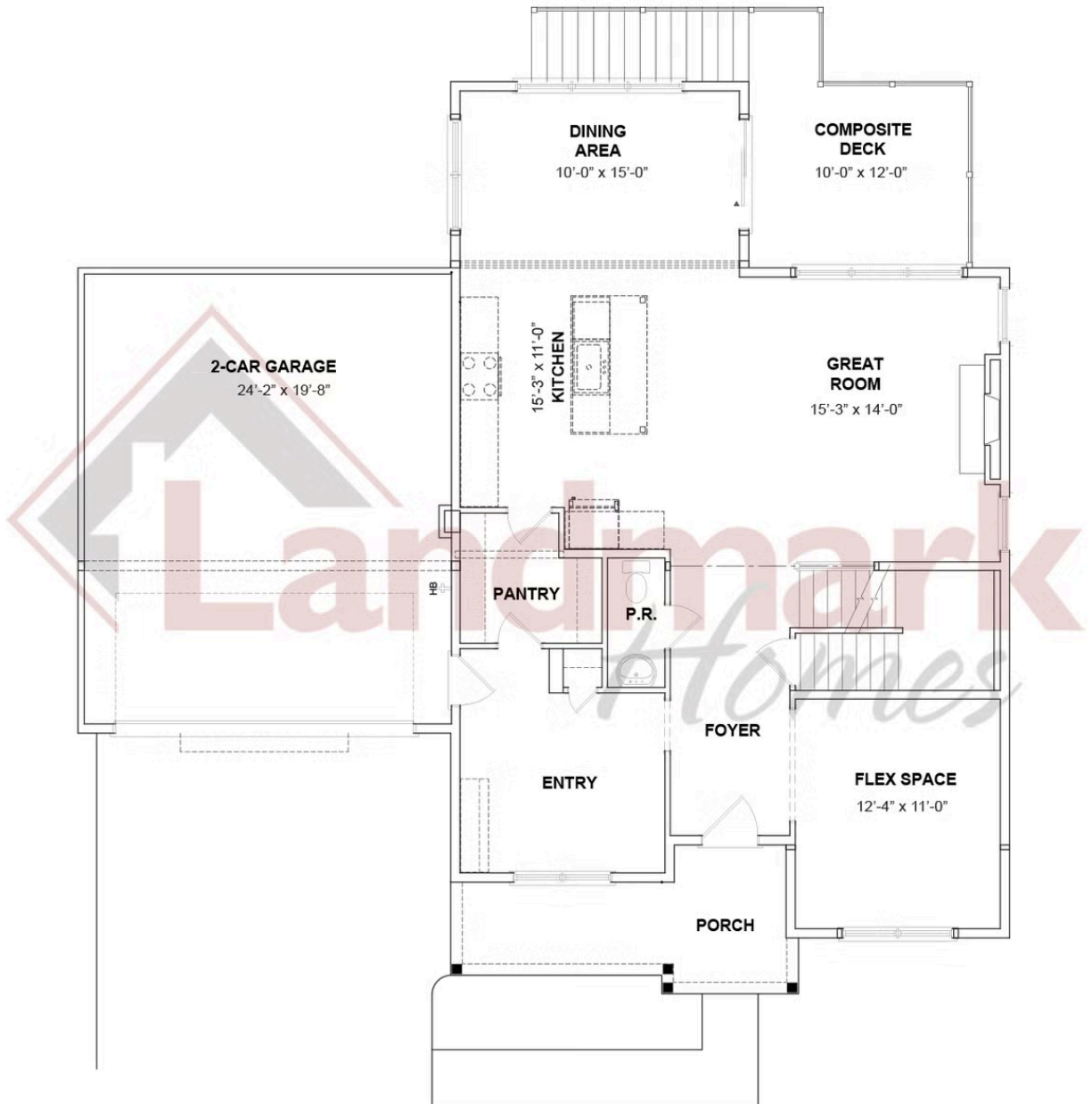

© 2025 Landmark Builders, Inc. We enforce our intellectual property rights to the fullest extent permitted by applicable law. Elevations and landscaping are artists' conceptions only. Floor plans may vary depending on elevation selected. Actual construction documents take precedence over artwork.





Single Family
217 Copper Ridge Drive
Newmanstown, PA 17073

COMMUNITY SALES MANAGER

Kristin Larusso
Call/Text 717-419-1611

SECOND FLOOR

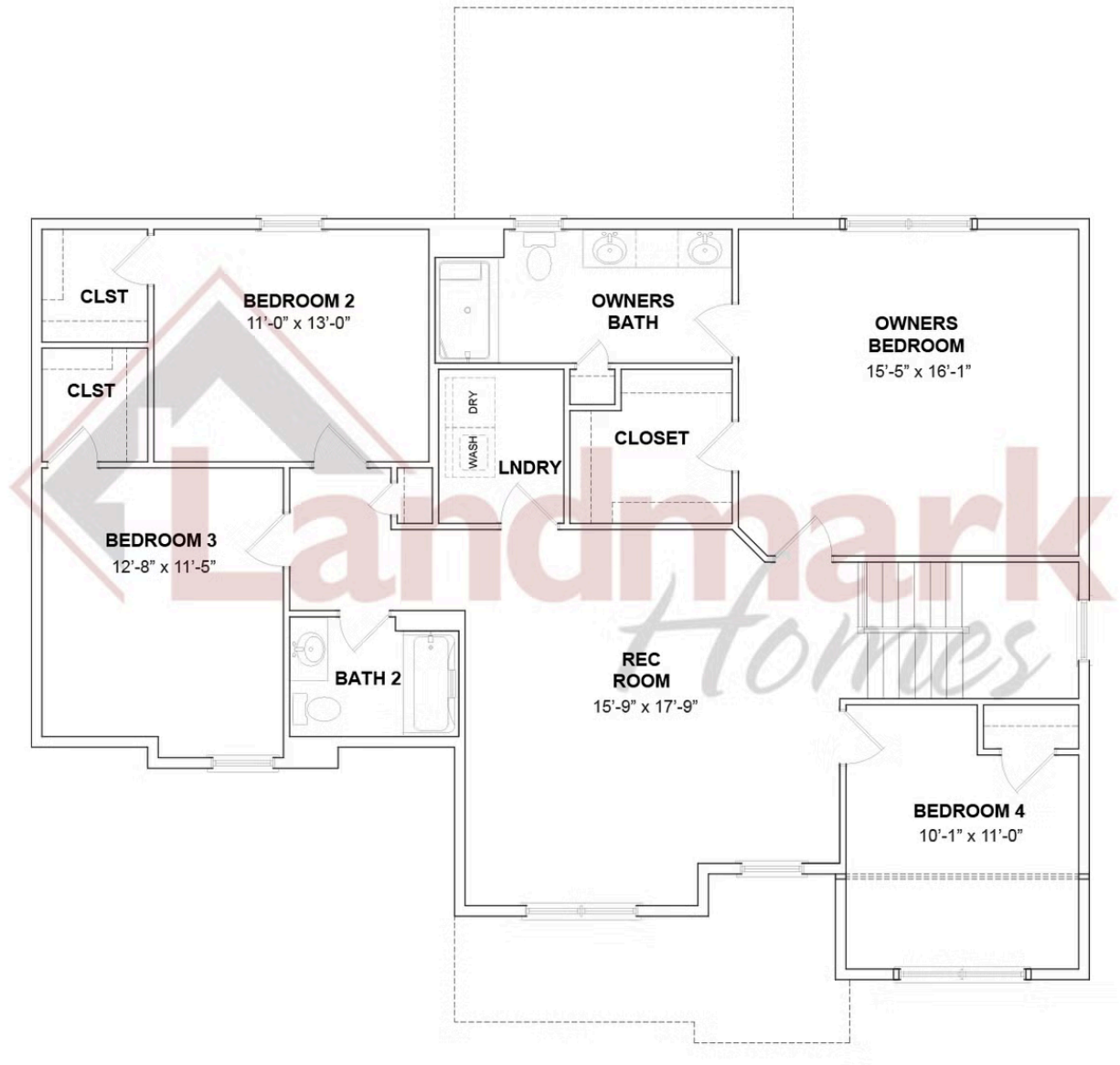

© 2025 Landmark Builders, Inc. We enforce our intellectual property rights to the fullest extent permitted by applicable law. Elevations and landscaping are artists' conceptions only. Floor plans may vary depending on elevation selected. Actual construction documents take precedence over artwork.

