



Single Family
515 Estate Drive
Mechanicsburg, PA 17055

COMMUNITY SALES MANAGER

Randy Brewbaker
Call/Text 717-587-1469

MOVE-IN READY



Home Priced at
\$579,700

Plan: Jensen

3 Bedrooms

2.5 Bathrooms

2,756 Sq. Ft.

This charming 2-story home features a 2-car, rear load garage with mudroom entry, a study, and a patio for outdoor living. The foyer opens to the great room warmed by a gas fireplace with floor to ceiling stone and a box beam mantel. Beautiful vinyl plank flooring flows throughout the main living areas. The kitchen is well-equipped with spacious pantry, upgraded appliances, quartz countertops with a tile backsplash, and a large center island that opens to the dining area. The owner's suite includes a private bathroom with a tile shower, a double bowl vanity and an expansive closet. The laundry room is located across the hall from the owner's bedroom. Three additional bedrooms, a full bathroom, and a loft can be found on the 2nd floor. (The floor plan shown represents the standard layout for this home plan. Actual layout, features, and options may vary. Construction plans take precedence over artwork. Please see the Community Sales Manager for details.)

Document generated 2/22/26





Single Family
515 Estate Drive
Mechanicsburg, PA 17055

COMMUNITY SALES MANAGER

Randy Brewbaker
Call/Text 717-587-1469

FIRST FLOOR

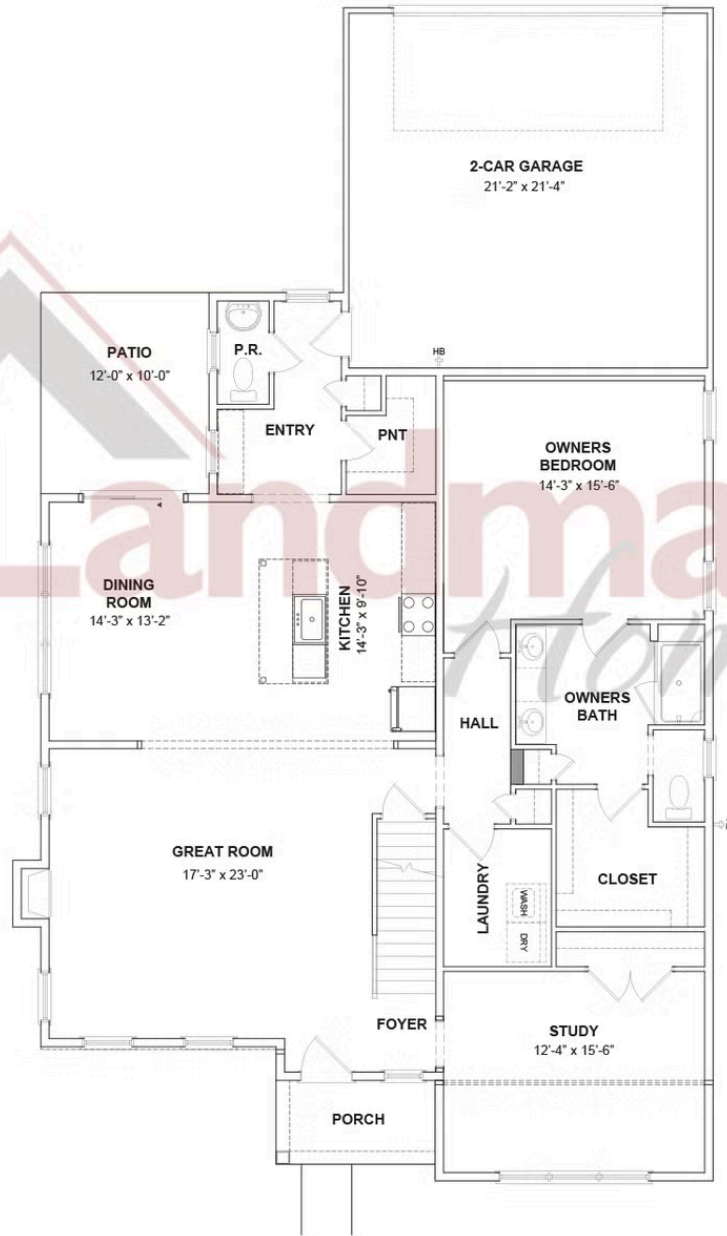

© 2025 Landmark Builders, Inc. We enforce our intellectual property rights to the fullest extent permitted by applicable law. Elevations and landscaping are artists' conceptions only. Floor plans may vary depending on elevation selected. Actual construction documents take precedence over artwork.





Single Family
515 Estate Drive
Mechanicsburg, PA 17055

COMMUNITY SALES MANAGER

Randy Brewbaker
Call/Text 717-587-1469

SECOND FLOOR

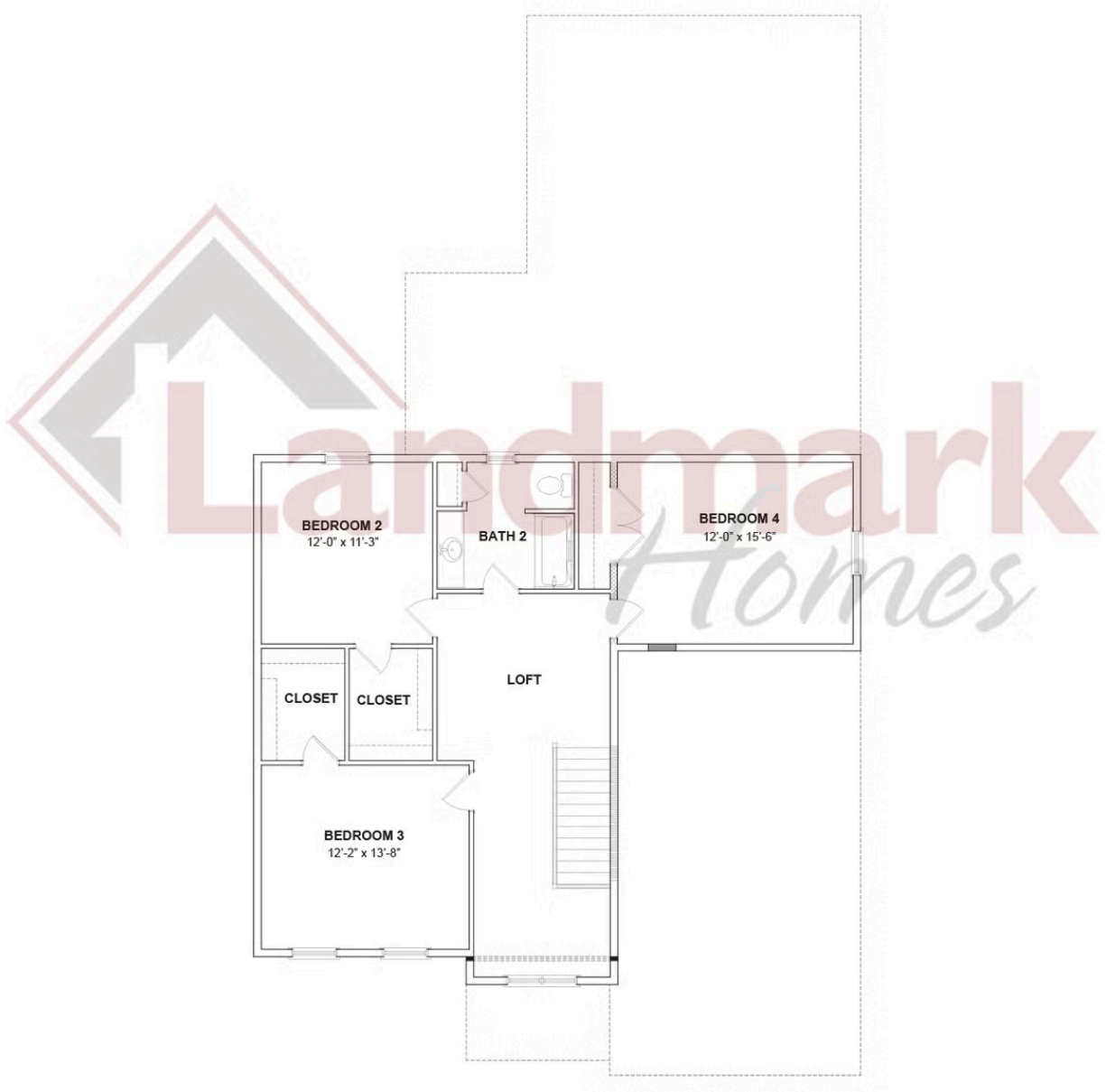

© 2025 Landmark Builders, Inc. We enforce our intellectual property rights to the fullest extent permitted by applicable law. Elevations and landscaping are artists' conceptions only. Floor plans may vary depending on elevation selected. Actual construction documents take precedence over artwork.

