



Single Family  
**15 Vista Court**  
Lititz, PA 17543

**COMMUNITY SALES MANAGER**

Christine Glover

Call/Text 717-344-8748

**UNDER CONSTRUCTION**



Home Priced at  
**\$704,900**

Plan: Benson

4 Bedrooms

2.5 Bathrooms

2,896 Sq. Ft.

**UNDER CONSTRUCTION – AVAILABLE THIS SPRING:** This charming home features an owner's suite on the main level, a 2-car, lower-level garage, and a patio for outdoor living. Upon entering the foyer, there is a private study and stairs to the main level. Stylish vinyl plank flooring flows throughout the main living areas. The kitchen is well-equipped with enhanced cabinetry and appliances, quartz countertops with tile backsplash, and a large pantry. The kitchen opens to the dining area and family room with a stunning floor-to-ceiling stone fireplace. To the rear of the home is the owner's suite featuring an expansive closet and a private bathroom with a tile shower and double bowl vanity. The upper level is complete with 3 bedrooms, a full bathroom, and a flex room that can be used as a second office, playroom or other versatile space.

Document generated 2/17/26





Single Family  
**15 Vista Court**  
Lititz, PA 17543

**COMMUNITY SALES MANAGER**

Christine Glover  
Call/Text 717-344-8748

## FIRST FLOOR

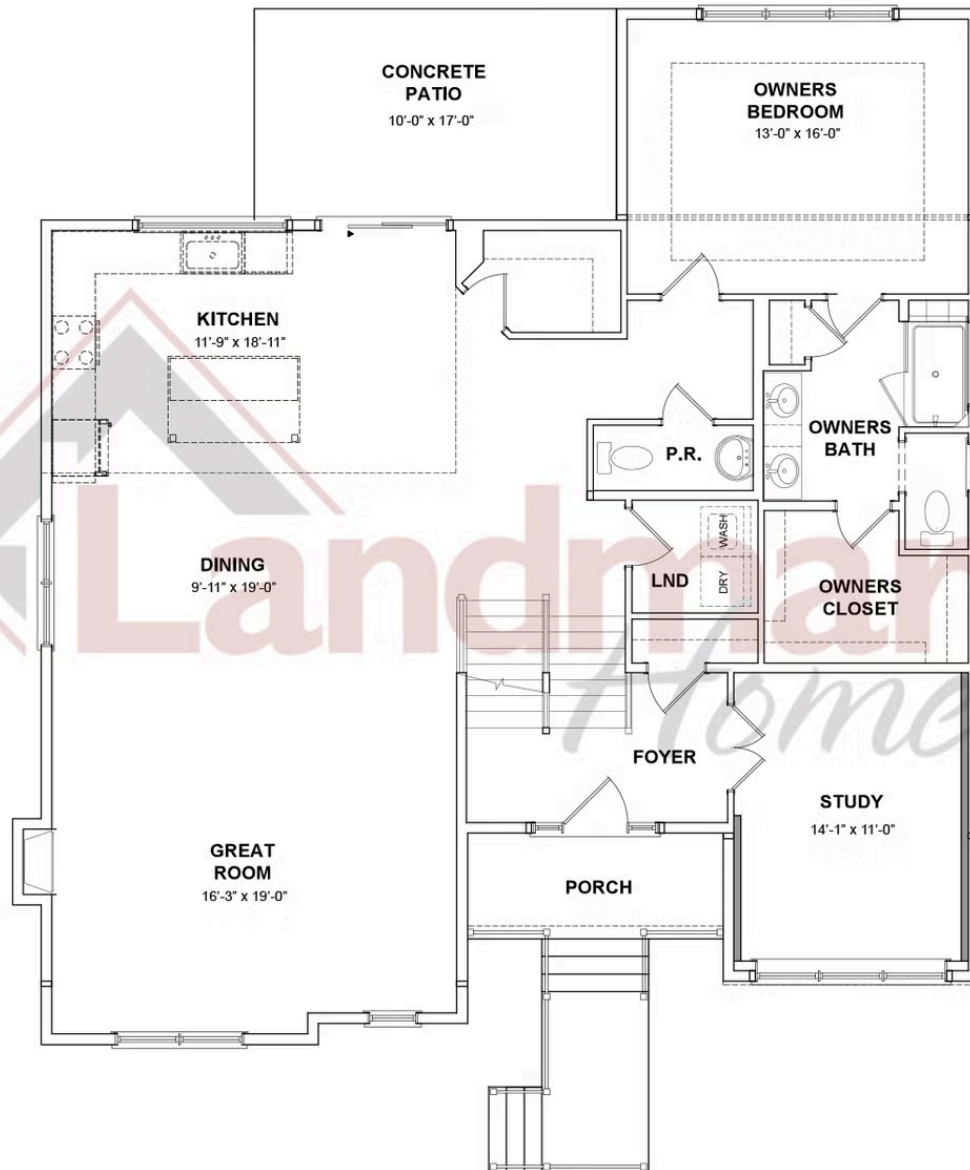

© 2025 Landmark Builders, Inc. We enforce our intellectual property rights to the fullest extent permitted by applicable law. Elevations and landscaping are artists' conceptions only. Floor plans may vary depending on elevation selected. Actual construction documents take precedence over artwork.

Document generated 2/17/26





Single Family  
**15 Vista Court**  
Lititz, PA 17543

**COMMUNITY SALES MANAGER**

Christine Glover  
Call/Text 717-344-8748

## SECOND FLOOR

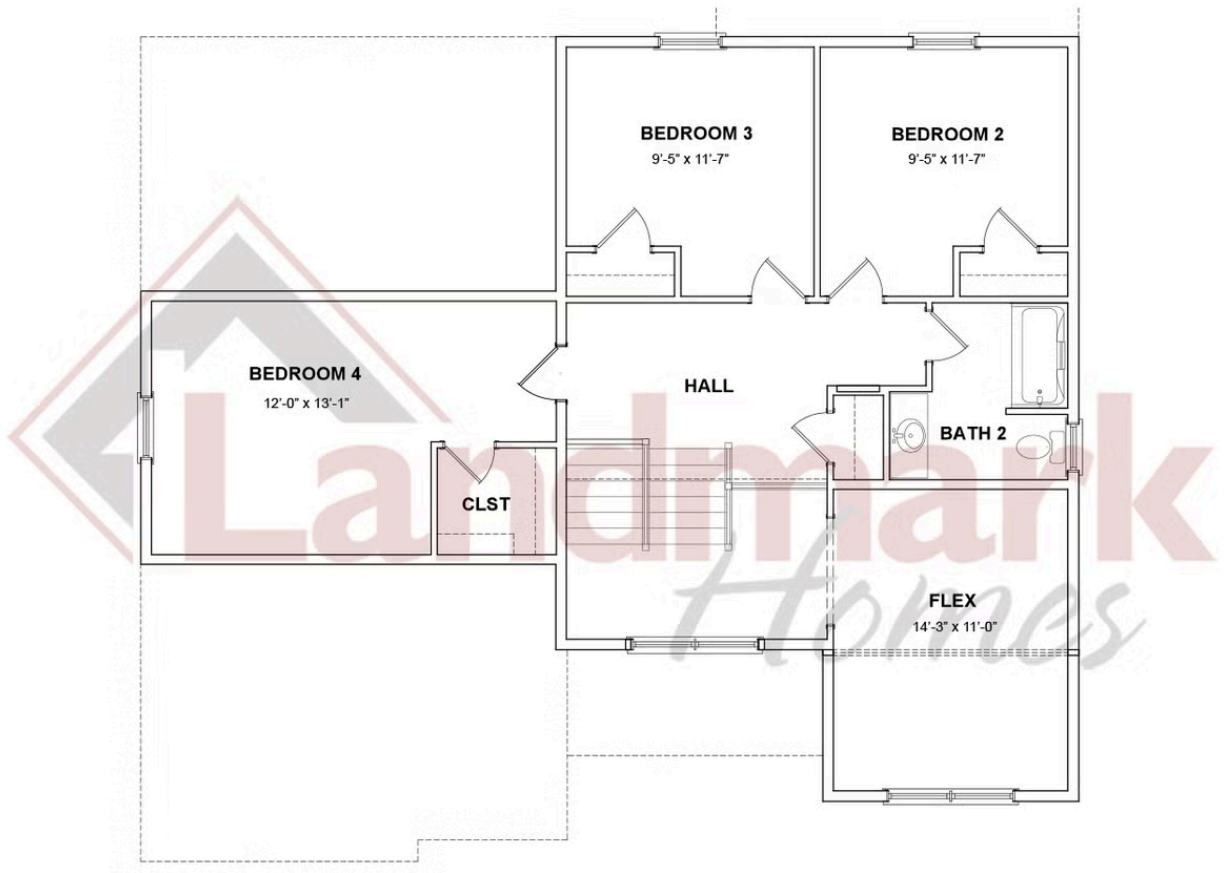

© 2025 Landmark Builders, Inc. We enforce our intellectual property rights to the fullest extent permitted by applicable law. Elevations and landscaping are artists' conceptions only. Floor plans may vary depending on elevation selected. Actual construction documents take precedence over artwork.

Document generated 2/17/26

