



Single Family

346 Aplomado Street

Denver, PA 17517

COMMUNITY SALES MANAGER

Kristin Larusso

Call/Text 717-419-1611

MOVE-IN READY



Home Priced at

\$794,900

Plan: Westbrooke

4 Bedrooms

2.5 Bathrooms

2,928 Sq. Ft.

This beautiful 2-story home includes a welcoming front porch, and a 3-car side-load garage with entry into a spacious laundry room. The thoughtfully designed, open floor plan features 9' ceilings in the basement and on the first floor and a 2-story foyer extending to the great room. Stylish vinyl plank flooring flows throughout the main living areas. A study is across the foyer from the formal dining room, highlighted by a tray ceiling and an accent wall. The kitchen is well-equipped with quartz countertops, a tile backsplash, stainless steel appliances, and a large center island and pantry. Next to the kitchen is a sunny breakfast area that provides access to the rear patio and the great room, warmed by a gas fireplace with a stone and decorative trim surround that creates the perfect focal point. Tucked quietly to the back of the home, the first-floor owner's suite has a private bathroom with a tile shower, double bowl vanity, and an expansive closet. There are 3 additional bedrooms and a full bathroom on the second floor.

Document generated 12/24/25





Single Family

346 Aplomado Street

Denver, PA 17517

COMMUNITY SALES MANAGER

Kristin Larusso

Call/Text 717-419-1611

FIRST FLOOR

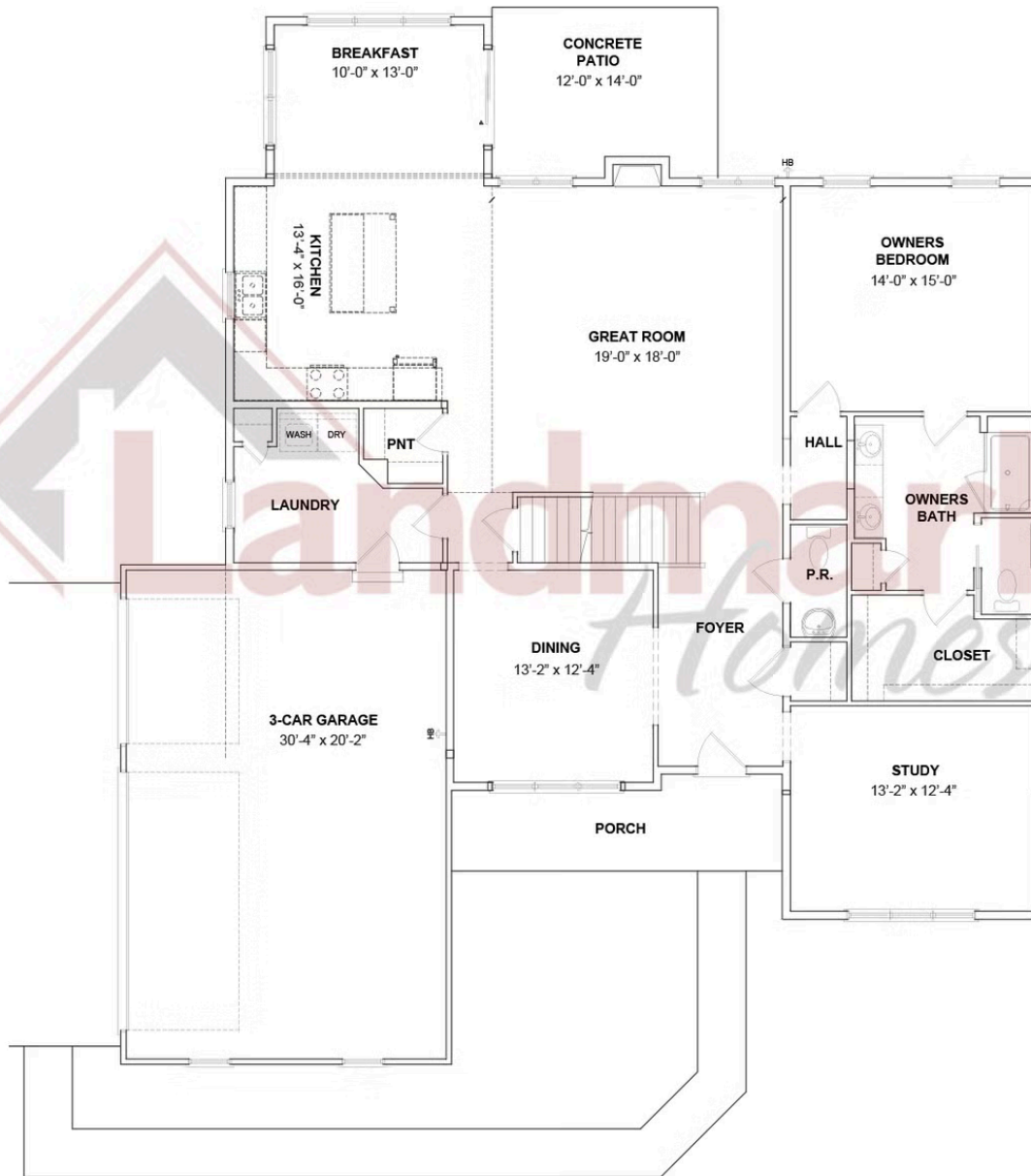

© 2025 Landmark Builders, Inc. We enforce our intellectual property rights to the fullest extent permitted by applicable law. Elevations and landscaping are artists' conceptions only. Floor plans may vary depending on elevation selected. Actual construction documents take precedence over artwork.

Document generated 12/24/25





Single Family
346 Aplomado Street
Denver, PA 17517

COMMUNITY SALES MANAGER
Kristin Larusso
Call/Text 717-419-1611

SECOND FLOOR

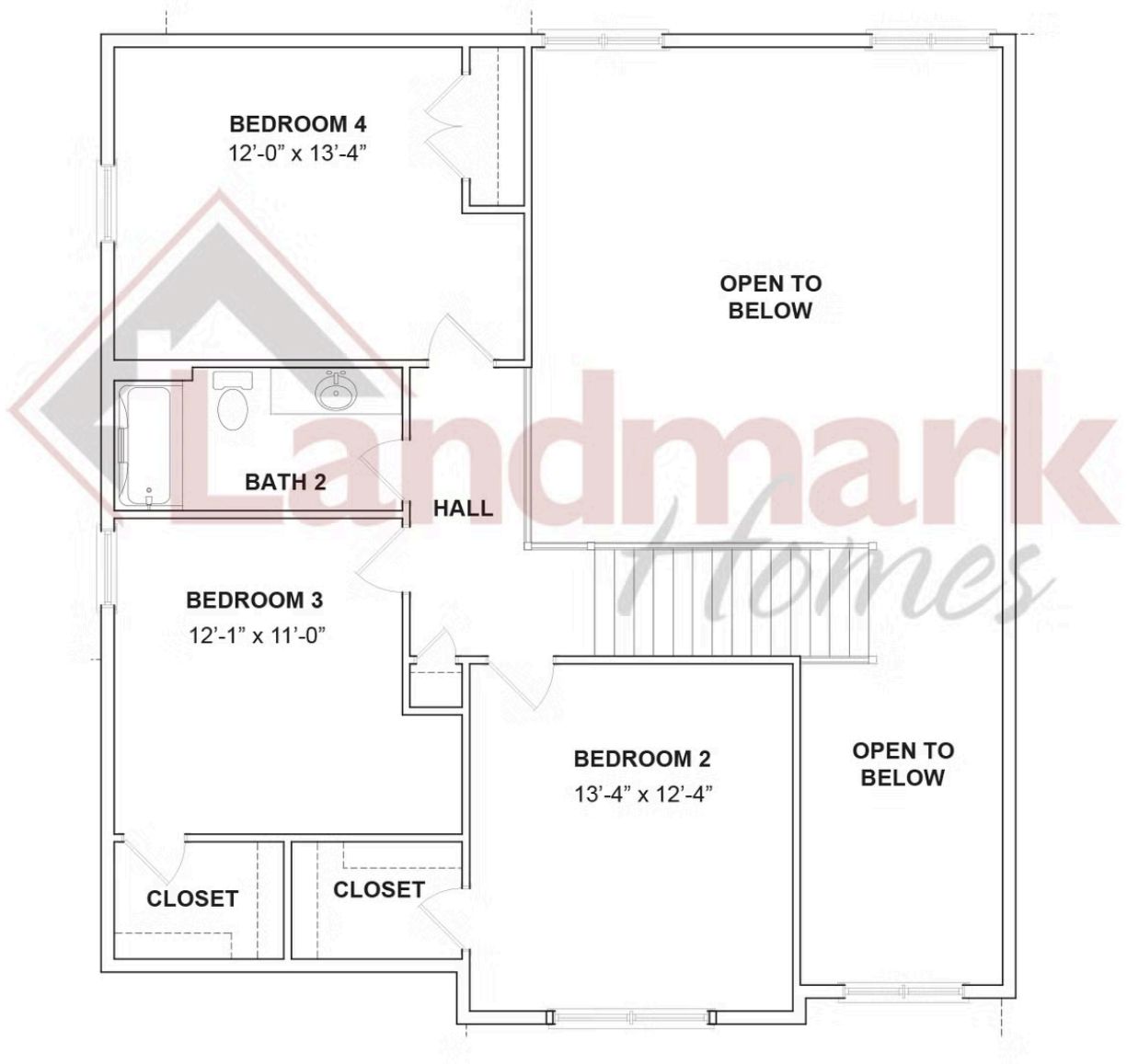

© 2025 Landmark Builders, Inc. We enforce our intellectual property rights to the fullest extent permitted by applicable law. Elevations and landscaping are artists' conceptions only. Floor plans may vary depending on elevation selected. Actual construction documents take precedence over artwork.

