



Single Family  
**224 West Valley Road**  
Denver, PA 17517

**COMMUNITY SALES MANAGER**

Kristin Larusso

Call/Text 717-419-1611

**UNDER CONSTRUCTION**



Home Priced at  
**\$919,900**

Plan: Callahan

Elevation: Callahan Exterior

4 Bedrooms

3.5 Bathrooms

3,681 Sq. Ft.

UNDER CONSTRUCTION – AVAILABLE THIS SUMMER: Designer details abound in this stately 2-story home with a craftsman style exterior, welcoming front porch, and a 1st floor owner's suite. The 3-car, side-load garage leads to a mudroom entry with built-in lockers and bench. To the front of the home is a versatile study and an elegant dining room with cathedral ceiling and stained wood beams. A convenient butler's pantry lays between the dining room and the open kitchen with quartz countertops, tile backsplash, enhanced cabinetry and appliances, and a large center island. The sunny breakfast area provides access to a spacious composite deck, perfect for entertaining or relaxing. The 2-story great room is warmed by a cozy fireplace with a tile surround. The well-appointed owner's suite with tray ceiling detail boasts a private bathroom with two vanities, a custom tile shower, freestanding tub, and an expansive closet. On the 2nd floor are 3 additional bedrooms with large closets, 2 full bathrooms, and a loft space. (The floor plan shown represents the standard layout for this home plan. Actual layout, features, and options may vary. Construction plans take precedence over artwork. Please see the Community Sales Manager for details.)

Document generated 4/8/26



### FIRST FLOOR

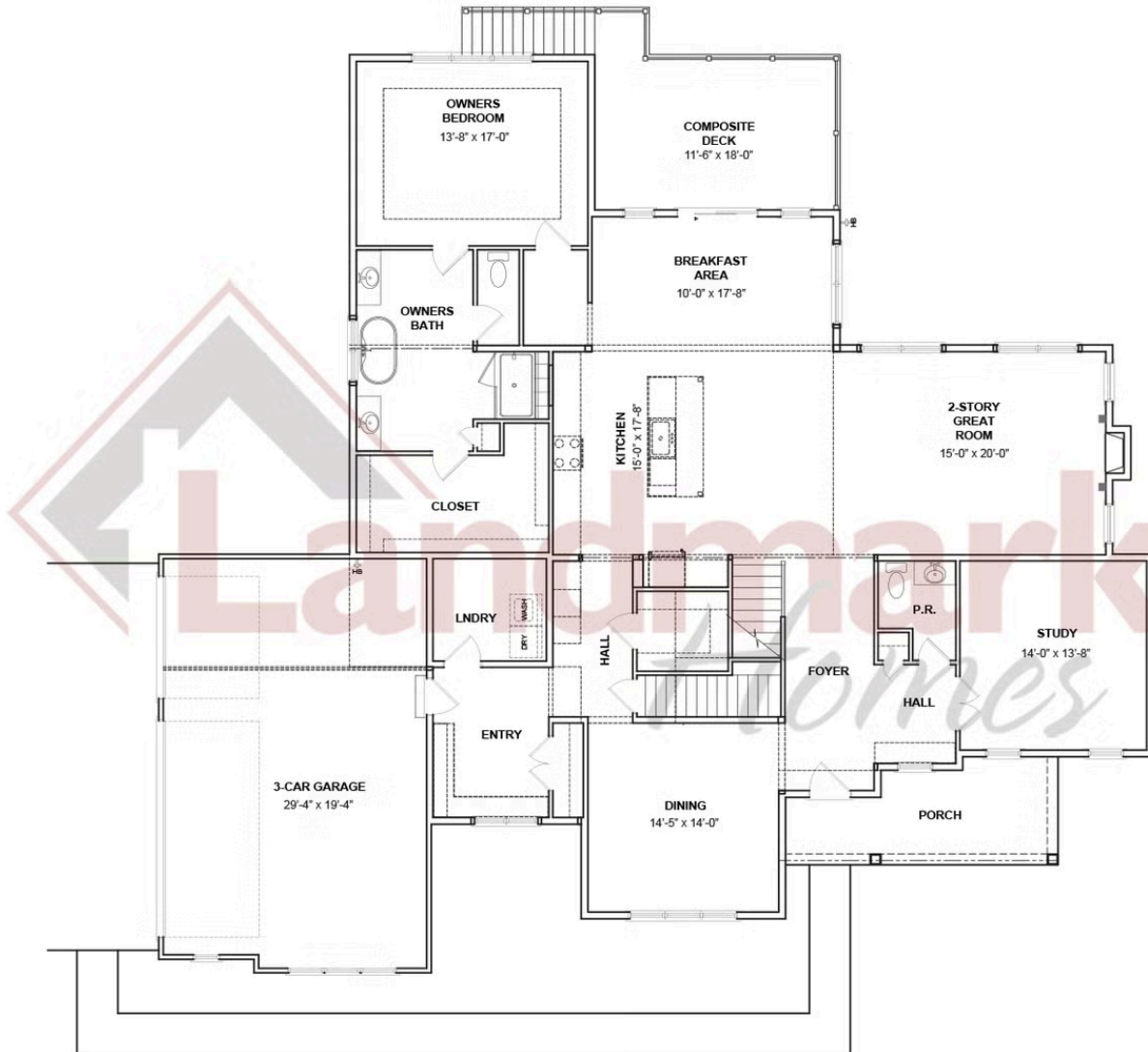

© 2026 Landmark Builders, Inc. We enforce our intellectual property rights to the fullest extent permitted by applicable law. Elevations and landscaping are artists' conceptions only. Floor plans may vary depending on elevation selected. Actual construction documents take precedence over artwork.

SECOND FLOOR

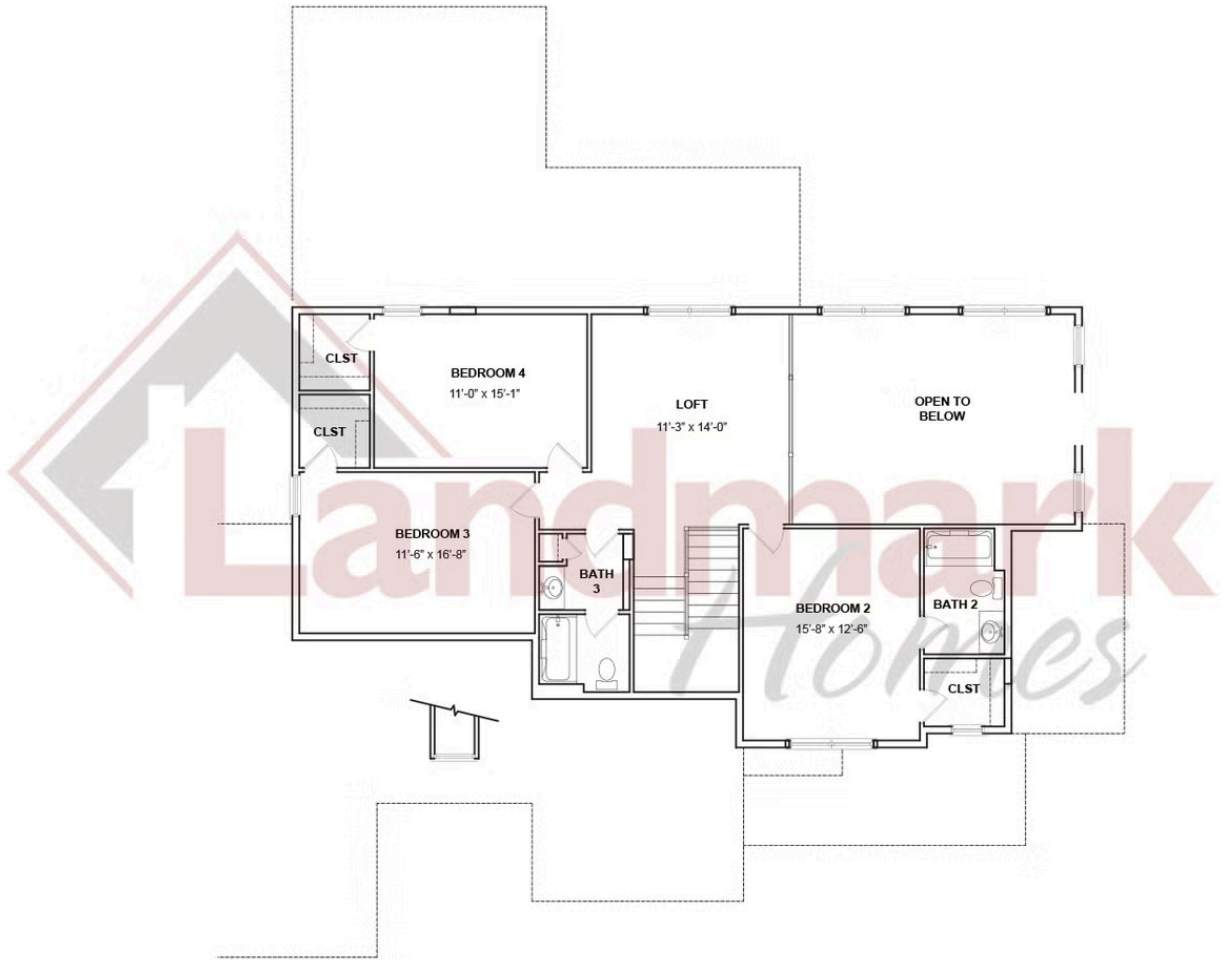

© 2026 Landmark Builders, Inc. We enforce our intellectual property rights to the fullest extent permitted by applicable law. Elevations and landscaping are artists' conceptions only. Floor plans may vary depending on elevation selected. Actual construction documents take precedence over artwork.