



MOVE-IN READY



Home Priced at \$559,900

JAMIE



BEDROOMS: 3



BATHROOMS: 2.0



SQ FT: 2,071

Winding Creek 55+ Living | 504 Hamilton Lane, Annville, PA 17003 | Homesite: #61

FIRST FLOOR

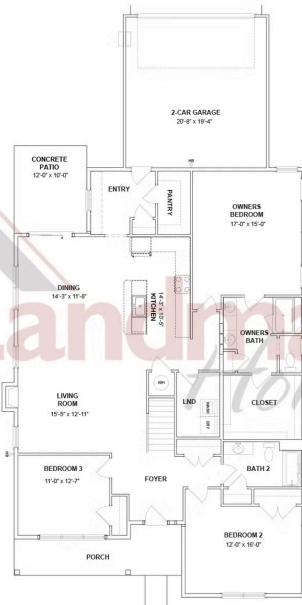

SECOND FLOOR



© 2025 Landmark Builders, Inc. We enforce our intellectual property rights to the fullest extent permitted by applicable law. Elevations and landscaping are artists' conceptions only. Floor plans may vary depending on elevation selected. Actual construction documents take precedence over artwork.

© 2025 Landmark Builders, Inc. We enforce our intellectual property rights to the fullest extent permitted by applicable law. Elevations and landscaping are artists' conceptions only. Floor plans may vary depending on elevation selected. Actual construction documents take precedence over artwork.

© 2026 Landmark Builders, Inc. We enforce our intellectual property rights to the fullest extent permitted by applicable law. Elevations and landscaping are artists' conceptions only. Actual construction documents take precedence over artwork. Similar photos shown are for representative purposes only. Details subject to change without notification. See Community Sales Manager for details.

Document generated 4/24/26

Call/Text Nicole Wamsher at 717-690-5746

info@OwnALandmark.com

OwnALandmark.com

