



Single Family

504 Hamilton Lane

Anncville, PA 17003

COMMUNITY SALES MANAGER

Nicole Wamsher

Call/Text 717-690-5746

MOVE-IN READY



Home Priced at

\$577,300

Plan: Jamie

3 Bedrooms

2.0 Bathrooms

2,071 Sq. Ft.

This charming 1-story home in our Winding Creek 55+ community includes a welcoming front porch, 9' ceilings, and an unfinished bonus room on the 2nd level. The 2-car, rear-load garage opens to a mudroom complete with a built-in bench and large pantry. At the front of the home, there are 2 bedrooms and a full bathroom. Stylish vinyl plank flooring in the foyer extends throughout the main living areas. The living room boasts a cathedral ceiling and a cozy gas fireplace with floor to ceiling stone. The kitchen features stainless steel appliances, attractive cabinetry and quartz countertops with a tile backsplash. The sunny dining area provides sliding glass door access to the rear patio. Tucked quietly to the back of the home, the owner's suite includes a private bathroom with a double bowl vanity, tile shower, and an oversized closet.

Document generated 12/22/25

Call/Text Anytime (717) 283-5790

info@ownalandmark.com

OwnALandmark.com





Single Family

504 Hamilton Lane

Annville, PA 17003

COMMUNITY SALES MANAGER

Nicole Wamsher

Call/Text 717-690-5746

FIRST FLOOR

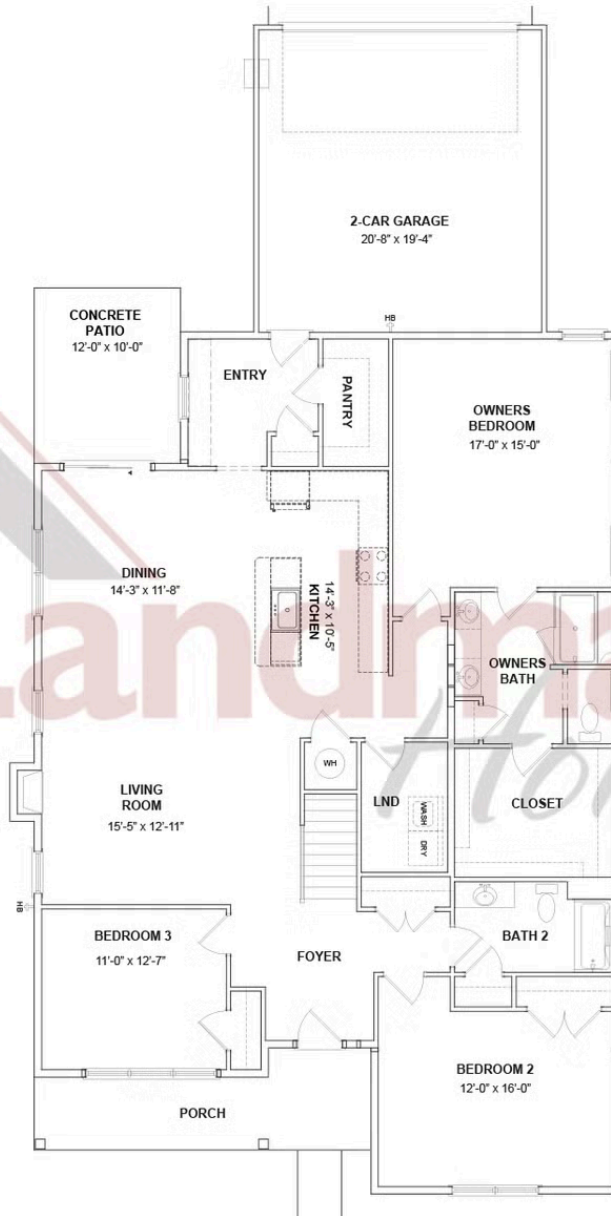

© 2025 Landmark Builders, Inc. We enforce our intellectual property rights to the fullest extent permitted by applicable law. Elevations and landscaping are artists' conceptions only. Floor plans may vary depending on elevation selected. Actual construction documents take precedence over artwork.





Single Family

504 Hamilton Lane

Annvile, PA 17003

COMMUNITY SALES MANAGER

Nicole Wamsher

Call/Text 717-690-5746

SECOND FLOOR

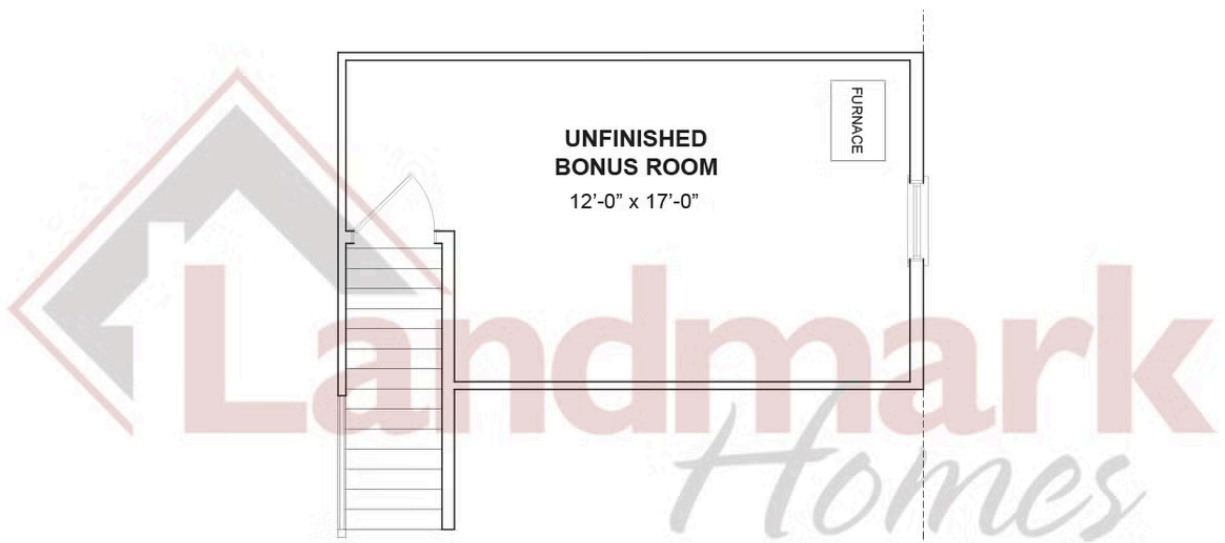

© 2025 Landmark Builders, Inc. We enforce our intellectual property rights to the fullest extent permitted by applicable law. Elevations and landscaping are artists' conceptions only. Floor plans may vary depending on elevation selected. Actual construction documents take precedence over artwork.

