



Single Family
475 Pinnacle Ridge Drive
Annville, PA 17003

COMMUNITY SALES MANAGER

Nicole Wamsher
Call/Text 717-690-5746

MOVE-IN READY



Home Priced at
\$599,900

Plan: Hazel

2 Bedrooms

2.0 Bathrooms

2,248 Sq. Ft.

This quaint home in the Winding Creek 55+ community features a welcoming front porch, a 2-car garage with a mudroom entry, and 9' ceilings on the first floor. Stylish vinyl plank flooring flows throughout the main living areas. At the front of the home is a study followed by a full bathroom and a secondary bedroom. The great room, warmed by a fireplace with floor-to-ceiling stone, opens to the well-appointed kitchen with enhanced appliances and cabinetry, quartz countertops with tile backsplash and a large pantry. The sunny dining area provides access to a screened-in porch. Tucked quietly to the back of the home, the spacious owner's suite includes an expansive closet and a private bathroom with a tile shower and double bowl vanity. On the second floor there is a loft and an unfinished storage room.

Document generated 12/24/25





Single Family
475 Pinnacle Ridge Drive
Annville, PA 17003

COMMUNITY SALES MANAGER

Nicole Wamsher

Call/Text 717-690-5746

FIRST FLOOR

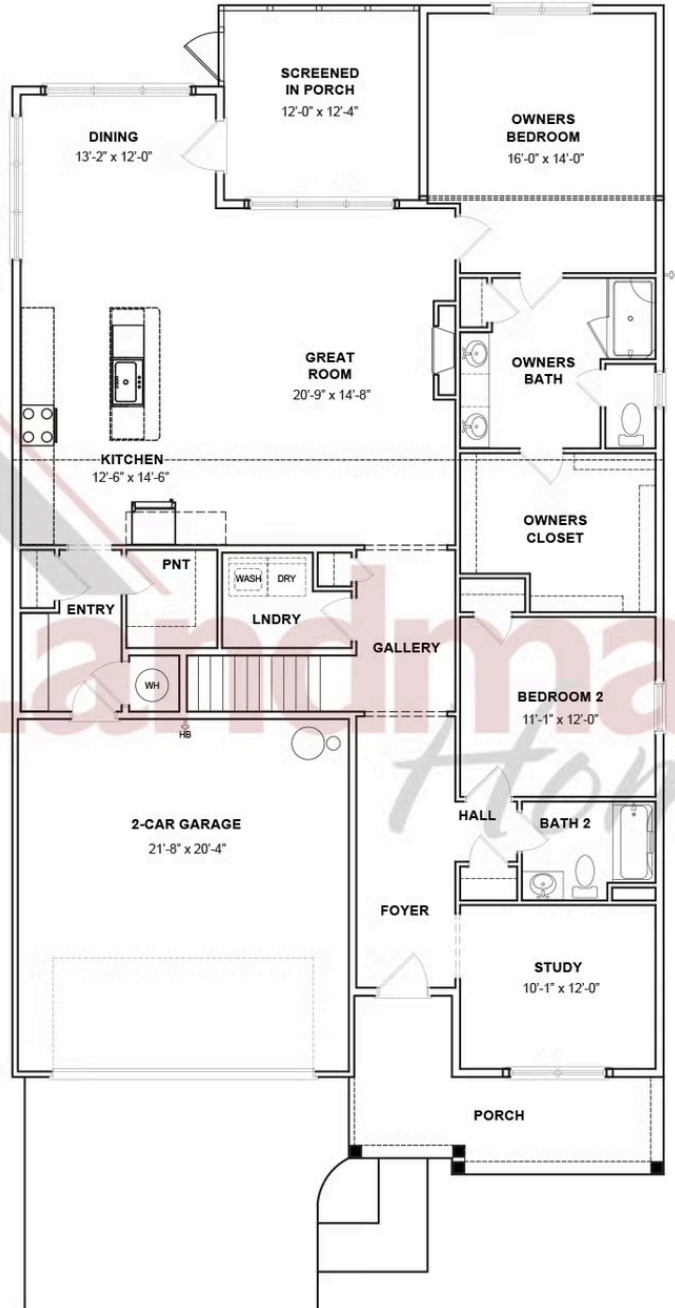

© 2025 Landmark Builders, Inc. We enforce our intellectual property rights to the fullest extent permitted by applicable law. Elevations and landscaping are artists' conceptions only. Floor plans may vary depending on elevation selected. Actual construction documents take precedence over artwork.





Single Family
475 Pinnacle Ridge Drive
Anville, PA 17003

COMMUNITY SALES MANAGER
Nicole Wamsher
Call/Text 717-690-5746

SECOND FLOOR

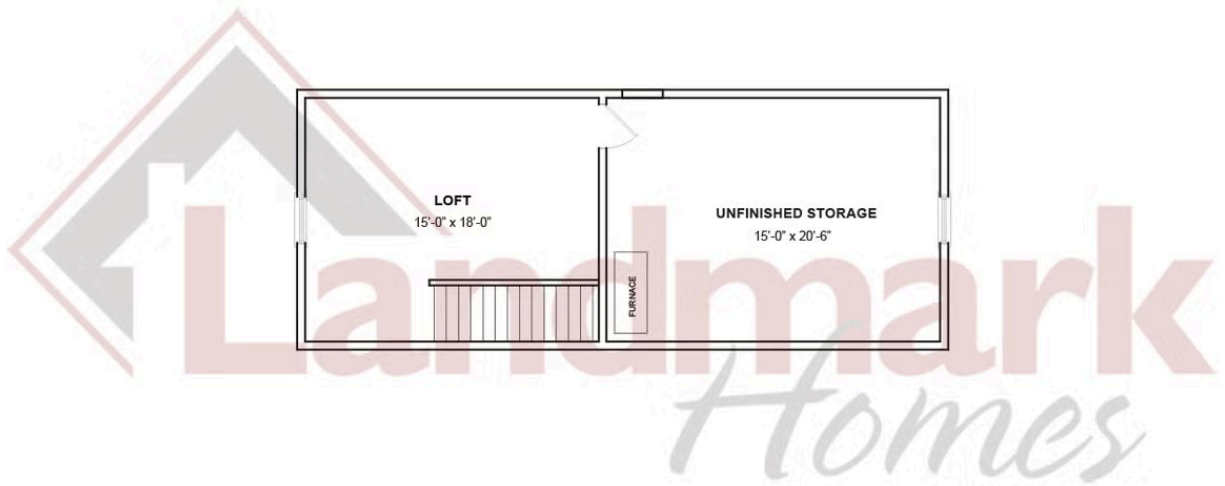

© 2025 Landmark Builders, Inc. We enforce our intellectual property rights to the fullest extent permitted by applicable law. Elevations and landscaping are artists' conceptions only. Floor plans may vary depending on elevation selected. Actual construction documents take precedence over artwork.

