



Duplex

529 Stone Gate Boulevard

Annville, PA 17003

COMMUNITY SALES MANAGER

Nicole Wamsher

Call/Text 717-690-5746

UNDER CONSTRUCTION



Home Priced at

\$480,600

Plan: Chelsea Duplex

3 Bedrooms

3.0 Bathrooms

2,125 Sq. Ft.

UNDER CONSTRUCTION – AVAILABLE THIS SPRING: Landmark's new duplex at Winding Creek 55+ is a thoughtfully designed 2-story home with 3 bedrooms, 3 full baths and a 2-car garage. The private side entry opens to the foyer and a formal dining room. The kitchen is well-equipped with stainless steel appliances, quartz countertops, a tile backsplash, and a large pantry. The great room features a tray ceiling and a cozy fireplace with a stone surround. A hallway from the great room leads to the patio access and two of the bedrooms, tucked quietly to the back of the home. The owner's suite has an oversized closet and a private bathroom with a tile shower double bowl vanity. On the second floor there is a 3rd bedroom, full bath, and a mechanical room with plenty of space for storage.





Duplex

529 Stone Gate Boulevard

Annville, PA 17003

COMMUNITY SALES MANAGER

Nicole Wamsher

Call/Text 717-690-5746

FIRST FLOOR

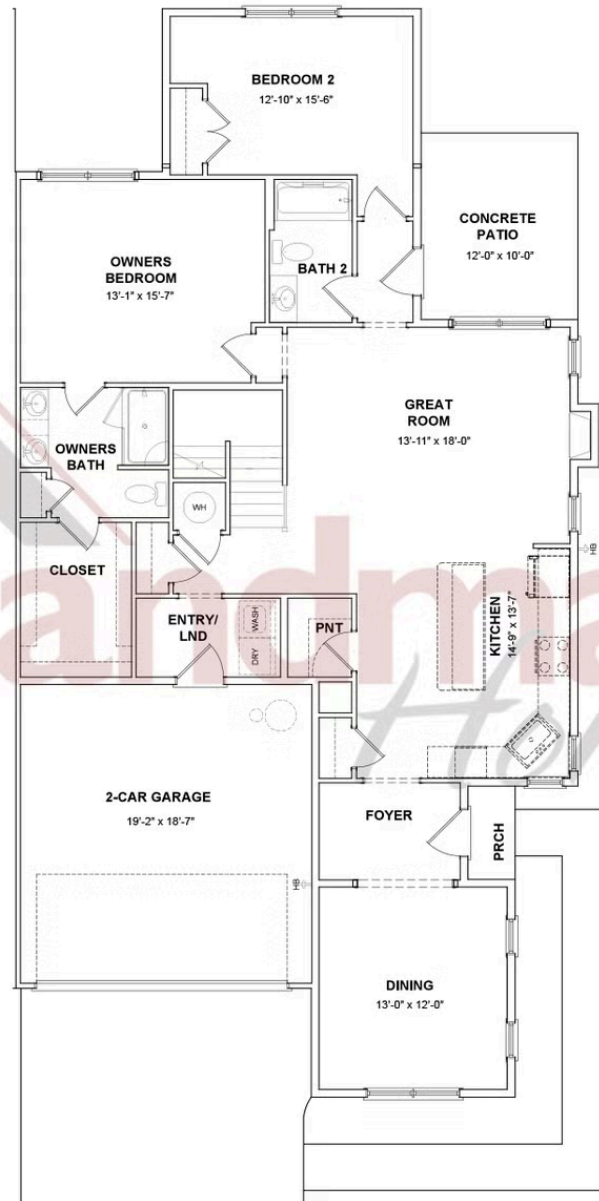

© 2025 Landmark Builders, Inc. We enforce our intellectual property rights to the fullest extent permitted by applicable law. Elevations and landscaping are artists' conceptions only. Floor plans may vary depending on elevation selected. Actual construction documents take precedence over artwork.





Duplex

529 Stone Gate Boulevard

Annville, PA 17003

COMMUNITY SALES MANAGER

Nicole Wamsher

Call/Text 717-690-5746

SECOND FLOOR

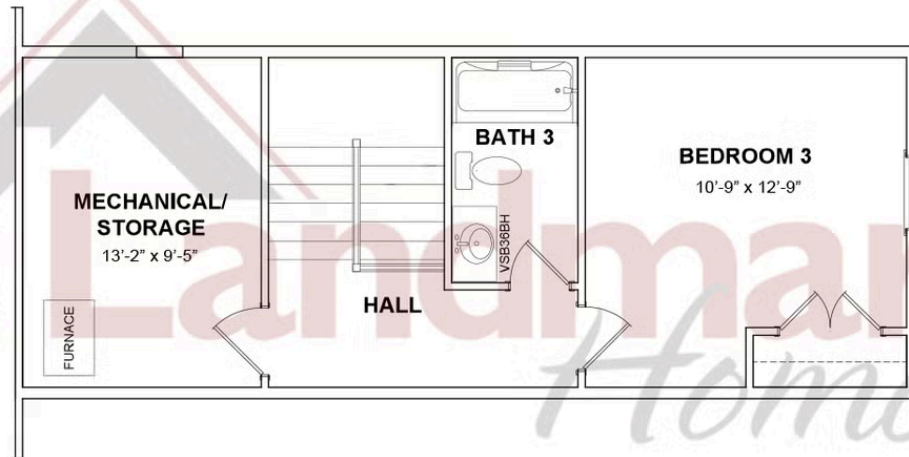

© 2025 Landmark Builders, Inc. We enforce our intellectual property rights to the fullest extent permitted by applicable law. Elevations and landscaping are artists' conceptions only. Floor plans may vary depending on elevation selected. Actual construction documents take precedence over artwork.

Document generated 2/22/26

