



Duplex
525 Stone Gate Boulevard
Annville, PA 17003

COMMUNITY SALES MANAGER

Nicole Wamsher
Call/Text 717-690-5746

UNDER CONSTRUCTION



Home Priced at
\$507,500

Plan: Bella Duplex

3 Bedrooms

3.0 Bathrooms

2,366 Sq. Ft.

UNDER CONSTRUCTION – AVAILABLE THIS SPRING: Landmark's new duplex at Winding Creek 55+ is a thoughtfully designed 2-story home with 3 bedrooms, 3 full baths, and a 2-car garage with a mudroom entry. The front entry opens to the foyer and second bedroom and bathroom, perfect for guests. The kitchen, well-appointed with quartz countertops, a tile backsplash, stainless steel appliances and a large pantry, is adjacent to the dining area and great room to create an open plan. The great room creates a grand first impression with its cathedral ceiling and cozy fireplace with a stone surround. Sliding glass doors in the great room provide access to the rear patio. Tucked quietly to the back of the home, the owner's suite features an oversized closet and a private bathroom with tile shower and double bowl vanity. On the second floor there is a loft, 3rd bedroom, full bath, and a mechanical room with plenty of space for storage.





Duplex
525 Stone Gate Boulevard
Annville, PA 17003

COMMUNITY SALES MANAGER

Nicole Wamsher
Call/Text 717-690-5746

FIRST FLOOR

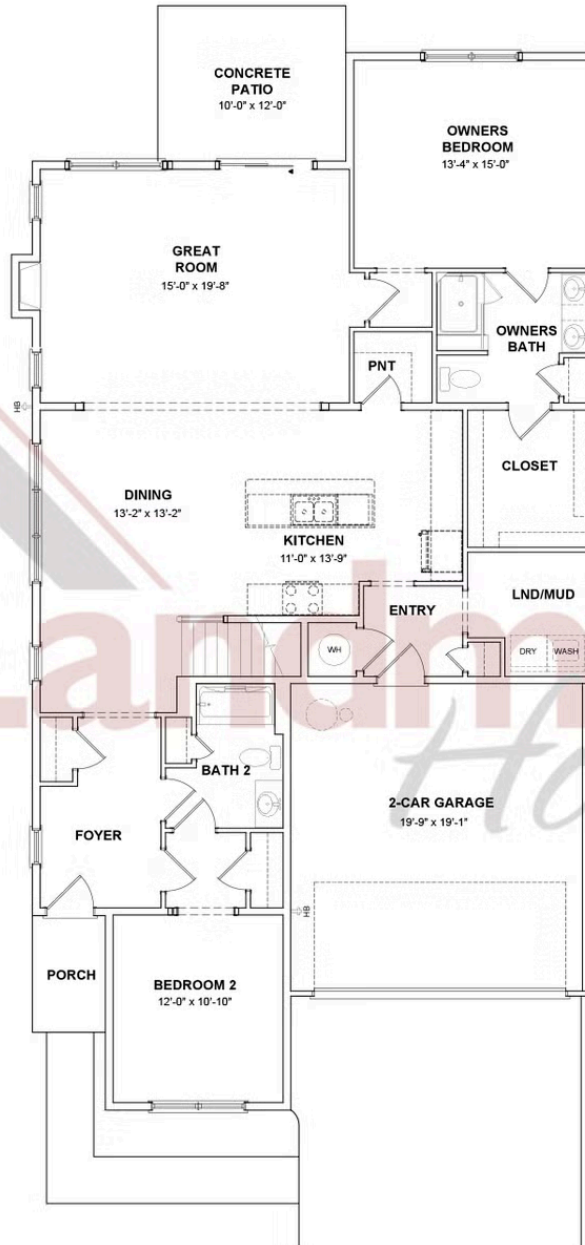

© 2025 Landmark Builders, Inc. We enforce our intellectual property rights to the fullest extent permitted by applicable law. Elevations and landscaping are artists' conceptions only. Floor plans may vary depending on elevation selected. Actual construction documents take precedence over artwork.





Duplex
525 Stone Gate Boulevard
Annville, PA 17003

COMMUNITY SALES MANAGER

Nicole Wamsher
Call/Text 717-690-5746

SECOND FLOOR

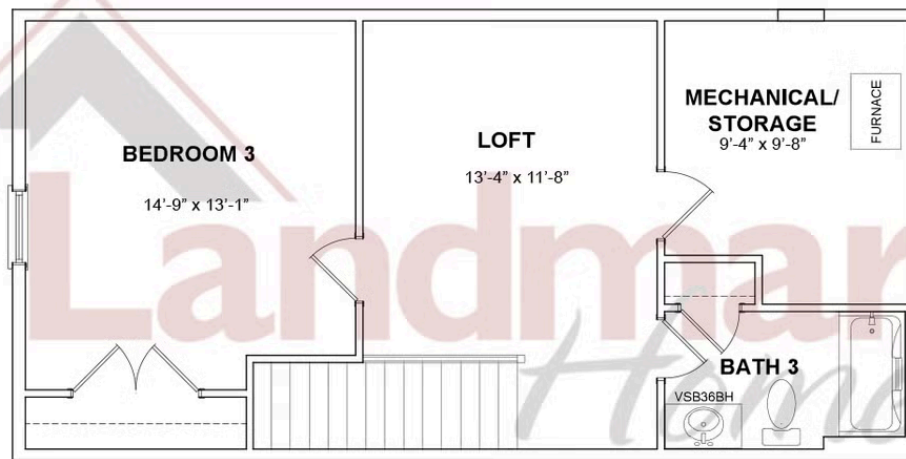

© 2025 Landmark Builders, Inc. We enforce our intellectual property rights to the fullest extent permitted by applicable law. Elevations and landscaping are artists' conceptions only. Floor plans may vary depending on elevation selected. Actual construction documents take precedence over artwork.

