



Single Family
122 Alexandria Dr
Annville, PA 17003

COMMUNITY SALES MANAGER

Lori Kahl

Call/Text 717-314-1448

MOVE-IN READY



Home Priced at
\$627,100

Plan: Magnolia

3 Bedrooms

2.5 Bathrooms

2,597 Sq. Ft.

This thoughtfully designed 2-story home with a first-floor owners' suite features an inviting front porch and a grand 2-story foyer and family room. The 2-car garage opens to a spacious mudroom complete with a built-in bench seat and laundry room access. Stylish vinyl plank flooring flows throughout the main living areas with a carpeted study to the front of the home. A formal dining room to the right of the foyer stands out with a beautiful accent painted tray ceiling. The kitchen, well-appointed with stainless steel appliances, quartz countertops, a tile backsplash, and large island and pantry, opens to a sunny breakfast area with access to the rear patio. Adjacent to the kitchen is the bright family room warmed by a gas fireplace with floor to ceiling stone that makes a stunning focal point in the room. The spacious owner's suite on the first floor includes a private bathroom with a tile shower, double bowl vanity and an expansive closet. On the 2nd floor are 2 additional bedrooms, a full bathroom, and loft space.

Document generated 2/22/26





Single Family
122 Alexandria Dr
Annville, PA 17003

COMMUNITY SALES MANAGER

Lori Kahl
Call/Text 717-314-1448

FIRST FLOOR

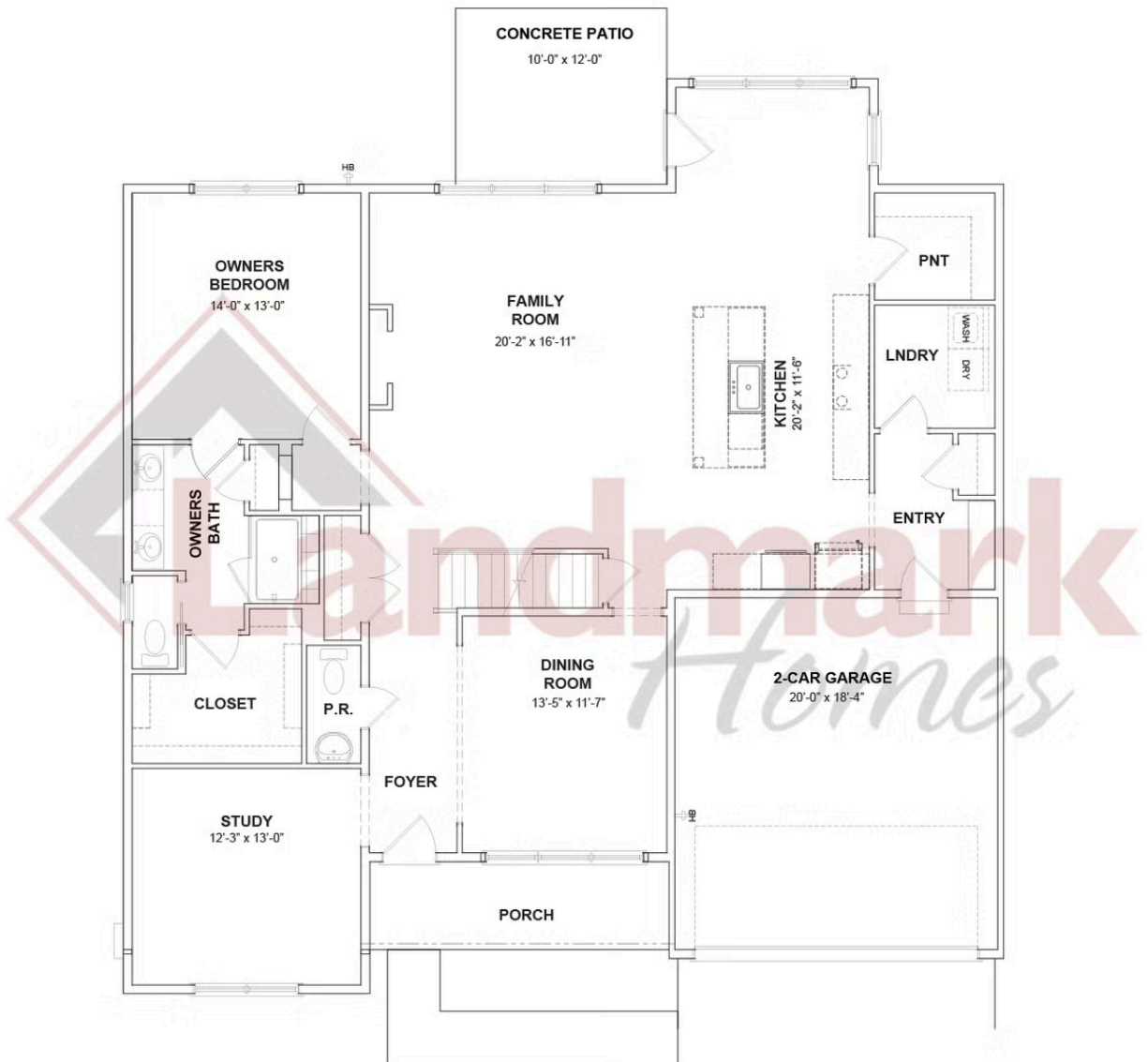

© 2025 Landmark Builders, Inc. We enforce our intellectual property rights to the fullest extent permitted by applicable law. Elevations and landscaping are artists' conceptions only. Floor plans may vary depending on elevation selected. Actual construction documents take precedence over artwork.





Single Family
122 Alexandria Dr
Annville, PA 17003

COMMUNITY SALES MANAGER

Lori Kahl
Call/Text 717-314-1448

SECOND FLOOR

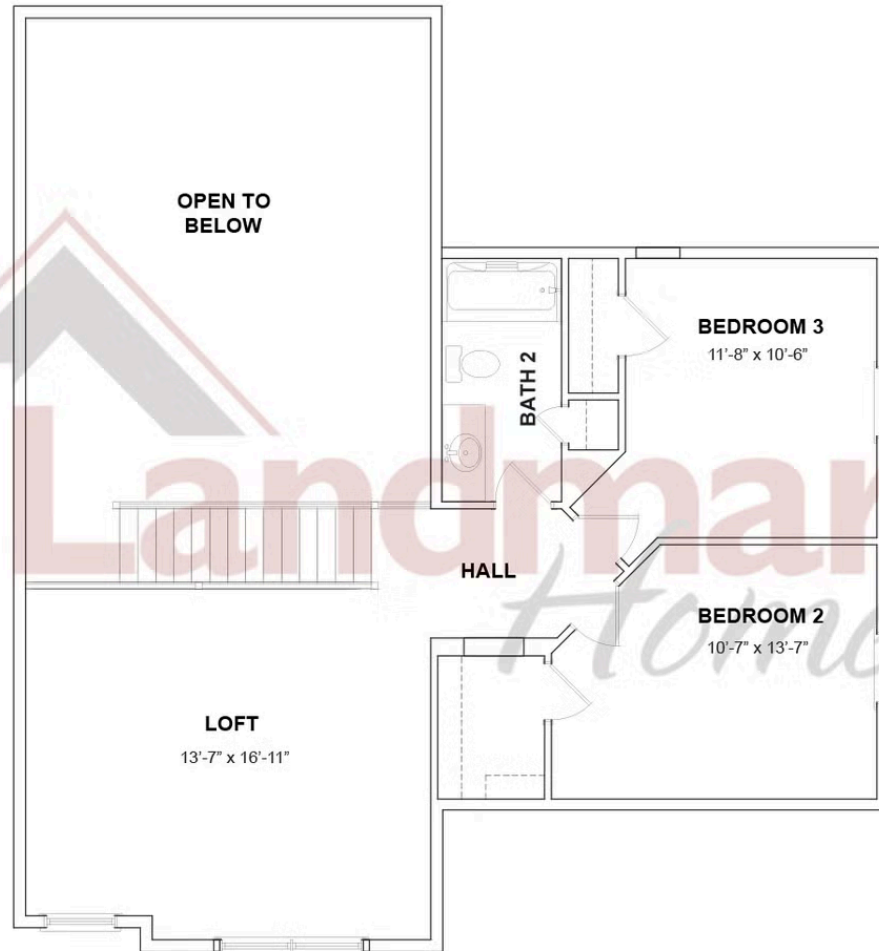

© 2025 Landmark Builders, Inc. We enforce our intellectual property rights to the fullest extent permitted by applicable law. Elevations and landscaping are artists' conceptions only. Floor plans may vary depending on elevation selected. Actual construction documents take precedence over artwork.

Document generated 2/22/26

