



Duplex
33 Canterbury Lane
Annville, PA 17003

COMMUNITY SALES MANAGER

Andrew Barshinger

Call/Text 717-371-6466

MOVE-IN READY



Home Priced at
\$419,900

Plan: Dogwood

2 Bedrooms

2.0 Bathrooms

1,688 Sq. Ft.

This brand-new luxury duplex at Edgemont Preserve epitomizes sophisticated one-floor living, seamlessly blending modern design with timeless comfort. Step into an expansive open-concept layout where the kitchen flows effortlessly into the spacious family room, featuring a modern electric fireplace creating an ideal setting for both entertaining and everyday living. The kitchen is a true centerpiece, featuring sleek stainless-steel appliances, elegant quartz countertops, and a large island perfect for casual dining or social gatherings.

The thoughtfully designed floor plan features nine-foot ceilings, two generously sized bedrooms, and two full bathrooms. The secluded owner's suite offers a serene retreat, complete with a dual-sink vanity, an expansive closet, and ensuite bath. Enhancing the home's versatility, the second floor provides ample storage space.

Located in Annville, PA within the Palmyra Area School District, Edgemont Preserve offers a charming small-town setting with unparalleled access to leisure, recreation, and everyday conveniences. Just minutes from the area's best dining, shopping, and premier attractions—including Hersheypark, the Giant Center, Mt. Gretna Lake, and several renowned golf courses—this exceptional community places you close to Hershey, Lebanon, and Harrisburg, with convenient access to Routes 422 and 322. Embrace the perfect harmony of luxury, comfort, and location in your new home at Edgemont Preserve. Contact the Community Sales Manager at 717-371-6466 today and discover everything Edgemont Preserve has to offer.

Document generated 2/22/26





Duplex
33 Canterbury Lane
Annville, PA 17003

COMMUNITY SALES MANAGER

Andrew Barshinger

Call/Text 717-371-6466

FIRST FLOOR

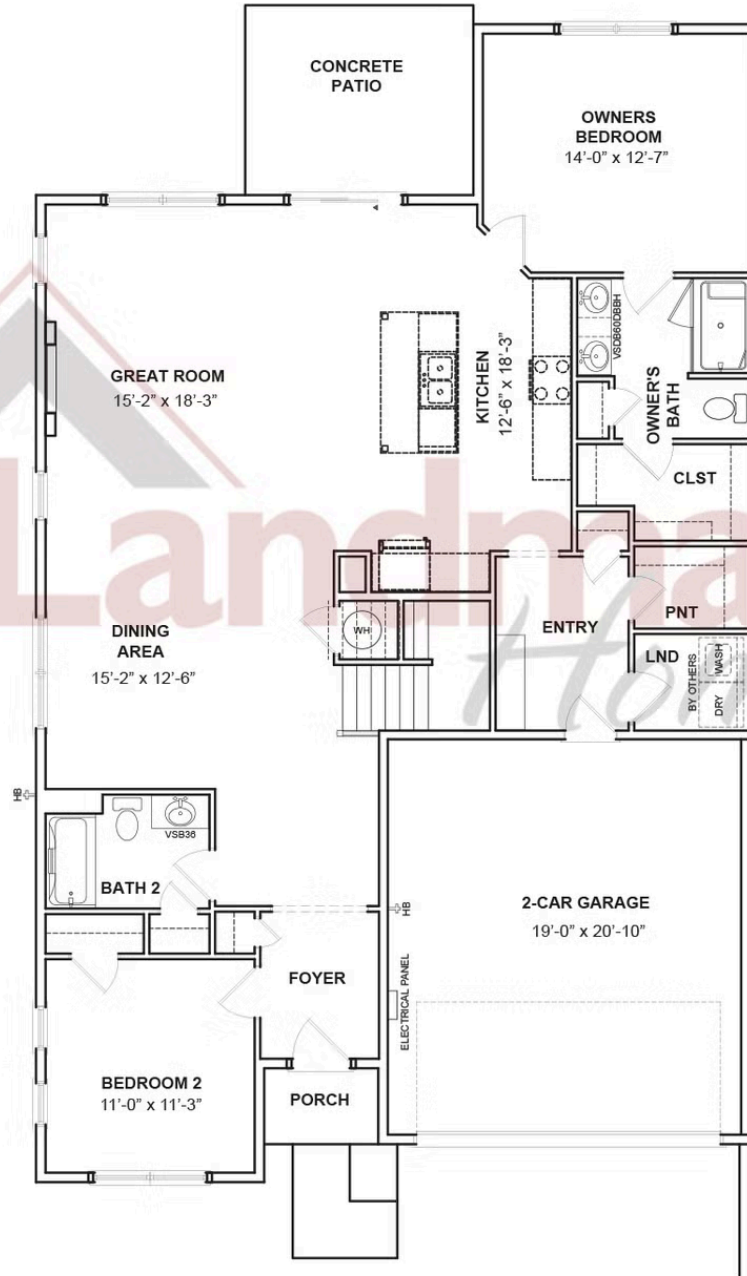

© 2025 Landmark Builders, Inc. We enforce our intellectual property rights to the fullest extent permitted by applicable law. Elevations and landscaping are artists' conceptions only. Floor plans may vary depending on elevation selected. Actual construction documents take precedence over artwork.





Duplex
33 Canterbury Lane
Annville, PA 17003

COMMUNITY SALES MANAGER

Andrew Barshinger
Call/Text 717-371-6466

SECOND FLOOR

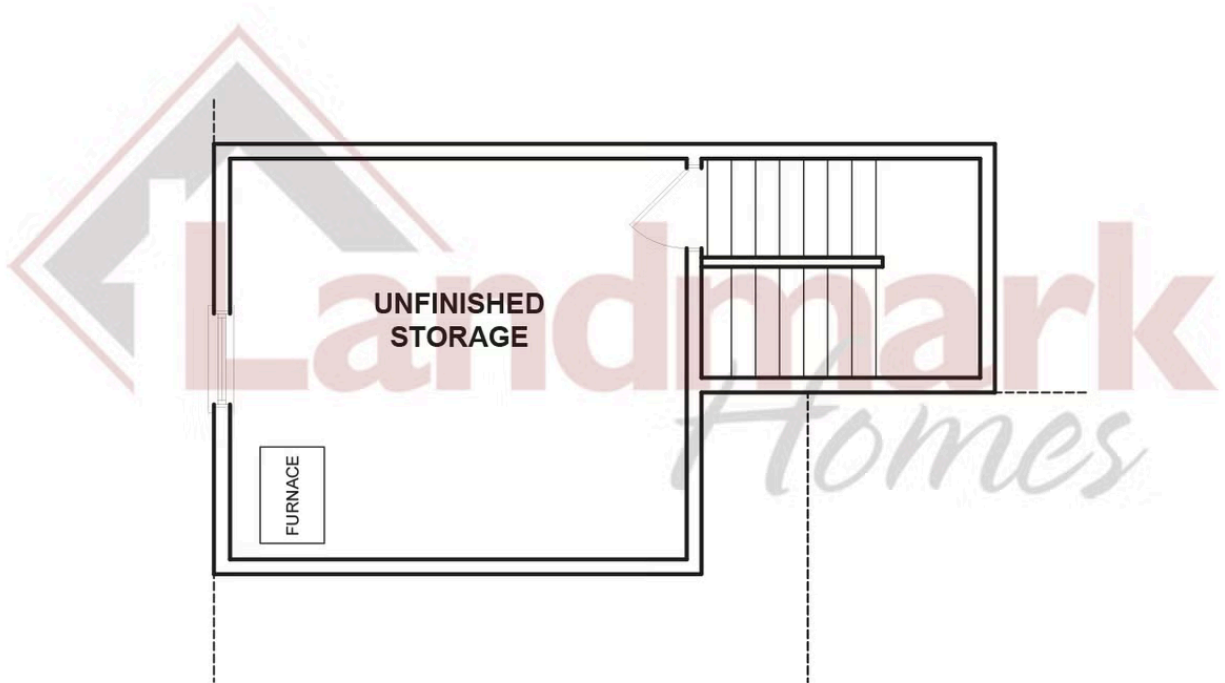

© 2025 Landmark Builders, Inc. We enforce our intellectual property rights to the fullest extent permitted by applicable law. Elevations and landscaping are artists' conceptions only. Floor plans may vary depending on elevation selected. Actual construction documents take precedence over artwork.

